

Storytelling Soother
Wyatt the Whale



vtech[®]
User's manual
(Canada version)

Congratulations

on purchasing your new VTech product. Before using this product, please read **Important safety instructions**.

This manual has all the feature operations and troubleshooting necessary to install and operate your new VTech product. Please review this manual thoroughly to ensure proper installation and operation of this innovative and feature rich VTech product.

For support, shopping, and everything new at VTech, visit our website at www.vtechcanada.com.

What's in the box

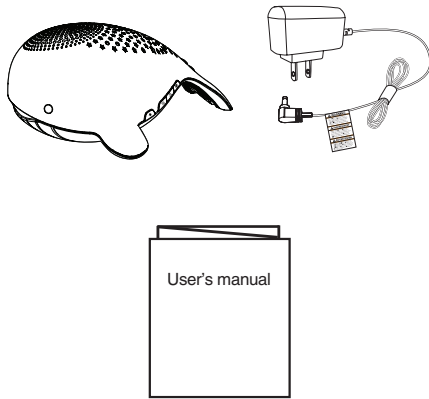

Connect the soother

NOTES

- Use only the power adapter supplied with this product.
- Make sure the electrical outlet is not controlled by a wall switch.
- The power adapter is intended to be correctly oriented in a vertical or floor mount position. The prongs are not designed to hold the plug in place if they are plugged into a ceiling, under-the-table or cabinet outlet.
- Make sure the soother and the power adapter cord are out of reach of children.

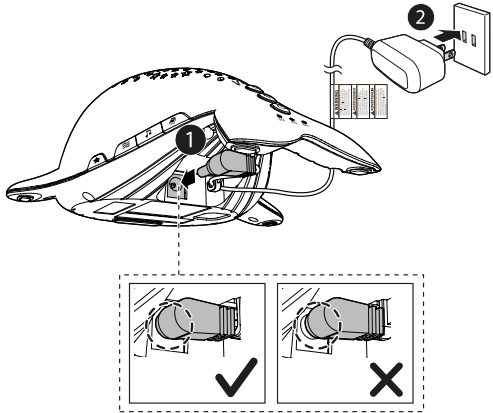

Position the soother

CAUTION

- Keep the soother out of the reach of your baby. Never place the soother inside the baby's crib or playpen.

Place the soother more than 3 feet (1 meter) away from your baby.

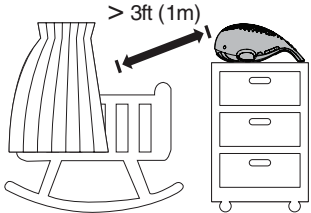

Overview

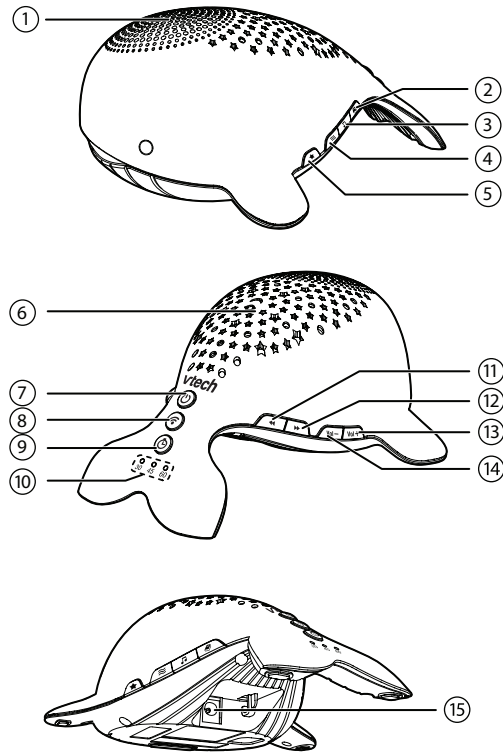

1	Speaker
2	Story <ul style="list-style-type: none">• Press to play or stop the story.
3	Lullaby <ul style="list-style-type: none">• Press to play or stop the lullaby.
4	Soothing sound <ul style="list-style-type: none">• Press to play or stop the soothing sound.
5	Glow-on-ceiling night light on/off <ul style="list-style-type: none">• Press to turn on or off the glow-on-ceiling night light.
6	Glow-on-ceiling night light

7	Power on/off <ul style="list-style-type: none">• Press to power on or off the soother.
8	Wi-Fi <ul style="list-style-type: none">• Press to turn on or off the soother's Wi-Fi network (for using with the Wyatt the Whale Storytelling Soother app).
9	Auto-off timer <ul style="list-style-type: none">• Press repeatedly to turn on and select an auto-off timer while playing story, lullaby or soothing sound. It will automatically stop the tracks after playing for 30/45/60 minutes.
10	Auto-off timer LED lights <ul style="list-style-type: none">• On when the respective duration is selected.• Off when the auto timer is turned off.
11	<ul style="list-style-type: none">• While playing a story, lullaby or soothing sound, press to play the previous track.
12	<ul style="list-style-type: none">• While playing a story, lullaby or soothing sound, press to play the next track.
13	Vol - <ul style="list-style-type: none">• Press to decrease the speaker volume.
14	Vol + <ul style="list-style-type: none">• Press to increase the speaker volume.
15	Power jack

Use the soother

Power on or off the soother

- Press to power on the soother.
- Press to power off the soother.

NOTE

- Make sure the soother is on before using other features.

Play the story

- Press to start playing stories.
- Press to skip to the next story.
- Press to play the previous story.
- While a story is playing, press to stop the story.

NOTES

- The soother will play the stories continuously unless you manually stop the stories or turn on the auto-off timer feature.
- When a story ends, the soother automatically skips to the next story. After the soother plays the last story in the story list, it restarts playing from the first story again.

Play the lullaby

- Press to start playing lullabies.
- Press to skip to the next lullaby.
- Press to play the previous lullaby.
- While a lullaby is playing, press to stop the lullaby.

NOTES

- The soother will play the lullabies continuously unless you manually stop the lullabies or turn on the auto-off timer feature.
- When a lullaby ends, the soother automatically skips to the next lullaby. After the soother plays the last lullaby in the lullaby list, it restarts playing from the first lullaby again.

Play the soothing sound

- Press to start playing soothing sounds.
- Press to play the next soothing sound.
- Press to play the previous soothing sound.
- While a soothing sound is playing, press to stop the soothing sound.

NOTES

- The soother will play the soothing sounds continuously unless you manually stop the soothing sounds or turn on the auto-off timer feature.
- The soother will repeat the same soothing sound again and again unless you skip to the other soothing sounds.

Adjust the speaker volume

- Press **Vol-** or **Vol+** at any time.

NOTE

- The soother beeps to notify you when the speaker volume is already at the highest or lowest setting while adjusting.

Set the auto-off timer

While the soother is playing story, lullaby or soothing sound, the auto-off timer feature helps you automatically stop the story, lullaby or soothing sound after playing for 30/45/60 minutes.

- While a story, lullaby or soothing sound is playing, press repeatedly to set the auto-off timer to **30**, **45** or **60** minutes. The respective auto-off timer LED light of the selected duration will turn on. The soother starts counting down 30/45/60 minutes.

After 30/45/60 minutes, the soother will automatically stop any story, lullaby or soothing sound. The auto-off timer feature and the auto-off timer LED lights will turn off.

NOTES

- You can only turn on the auto-off timer feature when the soother is playing story, lullaby or soothing sound.
- The auto-off timer feature will not power off the soother or turn off the glow-on-ceiling night light after the countdown.
- You can press again turn off the timer feature during the countdown.
- If you manually stop the story, lullaby or soothing sound while the auto-off timer is counting down, the auto-off timer will turn off.

Turn on or off the glow-on-ceiling night light

- While the soother is on, press to turn on the glow-on-ceiling night light.
- Press repeatedly to change the color of the glow-on-ceiling night light, or to turn it off.

NOTE

- The glow-on-ceiling nightlight will turn off automatically after 60 minutes.

Turn on or off the soother's Wi-Fi network (for app usage)

You can turn on the soother's Wi-Fi network for using the soother with the **Wyatt the Whale Storytelling Soother** mobile app.

- Press to turn on the Wi-Fi network. The light turns on.
- Press again to turn off the Wi-Fi network. The light turns off.

NOTES

- Turning on the soother's Wi-Fi network will stop all story, lullaby and soothing sound from playing. Make sure you turn off the soother's Wi-Fi network before playing any sounds.
- The soother's Wi-Fi network will be automatically off after 30 minutes if there is no data transfer.

For more information about the app, see **About Wyatt the Whale Storytelling Soother app**.

About Wyatt the Whale Storytelling Soother app

To enhance your experience on using the soother, you can use your BC8312 storytelling soother with the free, compatible mobile app.

Main features of the app:



- **My Library** stores extra free stories, lullabies and soothing sounds exclusive to the app. You can update your soother using the app and play these additional tracks on your soother.
- **Record Stories** allows you to record your own stories and messages. You can play these recordings on your soother.

NOTE

- Make sure your mobile device meets the minimum requirement for the mobile app:
 - Android® 4.3 or later; and
 - iOS 8.1 or later.

Install the app on your mobile device

1. Scan the QR codes below, or search "Wyatt the Whale" in the Google Play® store or App store.



Android



iOS

2. Download and install the "Wyatt the Whale Storytelling Soother" app.

Connect your mobile device to the soother

To access all features of the app, you need to connect your mobile device to the soother's Wi-Fi network first.

- If it is the first time you launch the app, the app prompts you to follow the instructions shown on screen to connect your mobile device to the soother's Wi-Fi network.
- If you have launched the app before:
 1. On the app home page, tap .
 2. Select **Connect to soother**.
 3. Follow the instructions shown on screen to connect your mobile device to the soother's Wi-Fi network.

NOTES

- The soother's Wi-Fi network is displayed as **Wyatt Whale Soother_XXXX** on the Wi-Fi list (XXXX are four random characters). The default Wi-Fi password is **SStoryteller** (case-sensitive).
- Up to three mobile devices can be connected to the soother's Wi-Fi network. Only one of the mobile devices can use the **My Library** feature at a time.

Access the app manual

For all instructions and troubleshooting on using the app, access the app manual and frequently asked questions in the app.

1. On the app home page, tap .
2. Select **App Manual** or **FAQ** to find the desired information.





General product care

To keep this soother working well and looking good, follow these guidelines:

- Avoid putting the soother near heating appliances and devices that generate electrical noise (for example, motors or fluorescent lamps).
- Avoid dropping the soother or treating it roughly.
- DO NOT expose the soother to direct sunlight or moisture.
- DO NOT use the soother in the rain, or handle it with wet hands.
- Clean with a soft cloth.
- DO NOT immerse the soother in water and do not clean it under the tap.
- DO NOT use cleaning spray or liquid cleaners.
- Make sure the soother is dry before you connect it to the any power sources.

Frequently asked questions

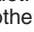
Below are the questions most frequently asked about the soother. If you cannot find the answer to your question, visit our website at www.vtechcanada.com, or contact **1 (800) 267-7377**.

The soother does not play sounds.	<p>The soother is not turned on.</p> <p>Make sure the power adapter is securely plugged into the soother and electrical outlet. Press  to power on the soother.</p>
	<p>You may have turned on the soother's Wi-Fi network.</p> <p>Make sure the soother's Wi-Fi network is off before you play any sounds. The  light should be off.</p>
The glow-on-ceiling night light does not turn on.	<p>The soother is not turned on.</p> <p>Make sure the power adapter is securely plugged into the soother and electrical outlet. Press  to power on the soother.</p>
When I press  to turn on the auto-off timer, the soother beeps.	<p>The auto-off timer feature is not turned on.</p> <p>Make sure you press  when the soother is playing a story, lullaby or soothing sound.</p>

Important safety instructions

When using your equipment, basic safety precautions should always be followed to reduce the risk of fire, electric shock and injury, including the following:

- Follow all warnings and instructions marked on the product.
- Adult setup is required.
- Do not use this product near water. For example, do not use it next to a bath tub, wash bowl, kitchen sink, laundry tub or swimming pool, or in a wet basement or shower.
- Use only the adapters included with this product. Incorrect adapter polarity or voltage can seriously damage the product.
Power adapter: Input: 100-120V AC 200mA 60Hz; Output: 6V DC 600mA
- The power adapters are intended to be correctly oriented in a vertical or floor mount position. The prongs are not designed to hold the plug in place if it is plugged into a ceiling, under-the-table or cabinet outlet.
- For pluggable equipment, the socket-outlet shall be installed near the equipment and shall be easily accessible.
- Unplug this product from the wall outlet before cleaning. Do not use liquid or aerosol cleaners. Use a damp cloth for cleaning.
- Do not cut off the power adapters to replace them with other plugs, as this causes a hazardous situation.
- Do not allow anything to rest on the power cords. Do not install this product where the cords may be walked on or crimped.
- This product should be operated only from the type of power source indicated on the marking label. If you are not sure of the type of power supply in your home, consult your dealer or local power company.
- Do not overload wall outlets or use an extension cord.
- Do not place this product on an unstable table, shelf, stand or other unstable surfaces.
- This product should not be placed in any area where proper ventilation is not provided. Slots and openings in the back or bottom of this product are provided for ventilation. To protect them from overheating, these openings must not be blocked by placing the product on a soft surface such as a bed, sofa or rug. This product should never be placed near or over a radiator or heat register.
- Never push objects of any kind into this product through the slots because they may touch dangerous voltage points or create a short circuit. Never spill liquid of any kind on the product.
- To reduce the risk of electric shock, do not disassemble this product, but take it to an authorized service facility. Opening or removing parts of the product other than specified access doors may expose you to dangerous voltages or other risks. Incorrect reassembling can cause

- electric shock when the product is subsequently used.
- Periodically examine all components for damage.
 - Children should be supervised to ensure that they do not play with the product.
 - The product is not intended for use by persons (including children) with reduced physical, sensory or mental capabilities, or lack of experience and knowledge, unless they have been given supervision or instruction concerning use of the appliance by a person responsible for their safety.

SAVE THESE INSTRUCTIONS

Cautions

- Use and store the product at a temperature between 32°F and 104°F.
- Do not expose the product to extreme cold, heat or direct sunlight. Do not put the product close to a heating source.
- Make sure the product and the adapter cord are always out of reach of the baby, at least 3 feet away from the baby or crib, to avoid a possible strangulation hazard.
- Never place the product inside the baby's crib or playpen. Never cover the product with anything such as a towel or a blanket.
- Other electronic products may cause interference with the product. Try installing the product as far away from these electronic devices as possible: wireless routers, radios, cellular telephones, intercoms, room monitors, televisions, personal computers, kitchen appliances and cordless telephones.

Precautions for users of implanted cardiac pacemakers

Cardiac pacemakers (applies only to digital cordless devices):

Wireless Technology Research, LLC (WTR), an independent research entity, led a multidisciplinary evaluation of the interference between portable wireless devices and implanted cardiac pacemakers. Supported by the U.S. Food and Drug Administration, WTR recommends to physicians that:

Pacemaker patients

- Should keep wireless devices at least six inches from the pacemaker.
- Should NOT place wireless devices directly over the pacemaker, such as in a breast pocket, when it is turned ON.

WTR's evaluation did not identify any risk to bystanders with pacemakers from other persons using wireless devices.

Electromagnetic fields (EMF)

This VTech product complies with all standards regarding electromagnetic fields (EMF). If handled properly and according to the instructions in this user's manual, the product is safe to be used based on scientific evidence available today.

FCC and IC regulations

FCC Part 15

This equipment has been tested and found to comply with the requirements for a Class B digital device under Part 15 of the Federal Communications Commission (FCC) rules. These requirements are intended to provide reasonable protection against harmful interference in a residential installation. This equipment generates, uses and can radiate radio frequency energy and, if not installed and used in accordance with the instructions, may cause harmful interference to radio communications. However, there is no guarantee that interference will not occur in a particular installation. If this equipment does cause harmful interference to radio or television reception, which can be determined by turning the equipment off and on, the user is encouraged to try to correct the interference by one or more of the following measures:

- Reorient or relocate the receiving antenna.
- Increase the separation between the equipment and receiver.
- Connect the equipment into an outlet on a circuit different from that to which the receiver is connected.
- Consult the dealer or an experienced radio/TV technician for help.

WARNING: Changes or modifications to this equipment not expressly approved by the party responsible for compliance could void the user's authority to operate the equipment.

This device complies with Part 15 of the FCC rules. Operation is subject to the following two conditions: (1) this device may not cause harmful interference, and (2) this device must accept any interference received, including interference that may cause undesired operation.

To ensure safety of users, the FCC has established criteria for the amount of radio frequency energy that can be safely absorbed by a user or bystander according to the intended usage of the product. This product has been tested and found to comply with the FCC criteria. The soother shall be installed and used such that parts of all persons' body are maintained at a distance of approximately 8 in (20 cm) or more.

This Class B digital apparatus complies with Canadian requirement:
CAN ICES-3 (B)/NMB-3(B)

Industry Canada

This device complies with Industry Canada licence-exempt RSS standard(s).

Operation is subject to the following two conditions: (1) this device may not cause harmful interference, and (2) this device must accept any interference, including interference that may cause undesired operation.

The term "IC:" before the certification/registration number only signifies that the Industry Canada technical specifications were met.

This product meets the applicable Innovation, Science and Economic Development Canada technical specifications.

RF radiation exposure statement

The soother complies with FCC RF radiation exposure limits set forth for an uncontrolled environment. The soother should be installed and operated with a minimum distance of 8 in (20 cm) between the soother and all persons' body. Use of other accessories may not ensure compliance with FCC RF exposure guidelines. This transmitter must not be co-located or operating in conjunction with any other antenna or transmitter. This equipment complies also with Industry Canada RSS-102 with respect to Canada's Health Code 6 for Exposure of Humans to RF Fields.

Limited warranty

What does this limited warranty cover?

The manufacturer of this VTech Product warrants to the holder of a valid proof of purchase ("Consumer" or "you") that the Product and all accessories provided in the sales package ("Product") are free from defects in material and workmanship, pursuant to the following terms and conditions, when installed and used normally and in accordance with the Product operating instructions. This limited warranty extends only to the Consumer for Products purchased and used in the United States of America and Canada.

What will VTech do if the Product is not free from defects in materials and workmanship during the limited warranty period ("Materially Defective Product")?

During the limited warranty period, VTech's authorized service representative will repair or replace at VTech's option, without charge, a Materially Defective Product. If we repair the Product, we may use new or refurbished replacement parts. If we choose to replace the Product, we may replace it with a new or refurbished Product of the same or similar design. We will retain defective parts, modules, or equipment. Repair or replacement of the Product, at VTech's option, is your exclusive remedy. VTech will return the repaired or replacement Products to you in working condition. You should expect the repair or replacement to take approximately 30 days.

How long is the limited warranty period?

The limited warranty period for the Product extends for ONE (1) YEAR from the date of purchase. If VTech repairs or replaces a Materially Defective Product under the terms of this limited warranty, this limited warranty also applies to the repaired or replacement Product for a period of either (a) 90 days from the date the repaired or replacement Product is shipped to you or (b) the time remaining on the original one-year warranty; whichever is longer.

What is not covered by this limited warranty?

This limited warranty does not cover:

- Product that has been subjected to misuse, accident, shipping or other physical damage, improper installation, abnormal operation or handling, neglect, inundation, fire, water or other liquid intrusion; or
- Product that has been damaged due to repair, alteration or modification by anyone other than an authorized service representative of VTech; or
- Product to the extent that the problem experienced is caused by signal conditions, network reliability, or cable or antenna systems; or
- Product to the extent that the problem is caused by use with non-VTech accessories; or
- Product whose warranty/quality stickers, product serial number plates or electronic serial numbers have been removed, altered or rendered illegible; or
- Product purchased, used, serviced, or shipped for repair from outside the United States of America or Canada, or used for commercial or institutional purposes (including but not limited to Products used for rental purposes); or
- Product returned without a valid proof of purchase (see item 2 on the next column); or
- Charges for installation or set up, adjustment of customer controls, and installation or repair of systems outside the unit.

How do you get warranty service?

To obtain warranty service, please visit our website at www.vtechcanada.com or call 1 (800) 267-7377.

NOTE: Before calling for service, please review the user's manual - a check of the Product's controls and features may save you a service call.

Except as provided by applicable law, you assume the risk of loss or damage during transit and transportation and are responsible for delivery or handling charges incurred in the transport of the Product(s) to the service location. VTech will return repaired or replaced Product under this limited warranty. Transportation, delivery or handling charges are prepaid. VTech assumes no risk for damage or loss of the Product in transit. If the Product failure is not covered by this limited warranty, or proof of purchase does not meet the terms of this limited warranty, VTech will notify you and will request that you authorize the cost of repair prior to

any further repair activity. You must pay for the cost of repair and return shipping costs for the repair of Products that are not covered by this limited warranty.

What must you return with the Product to get warranty service?

- Return the entire original package and contents including the Product to the VTech service location along with a description of the malfunction or difficulty; and
- Include a "valid proof of purchase" (sales receipt) identifying the Product purchased (Product model) and the date of purchase or receipt; and
- Provide your name, complete and correct mailing address, and telephone number.

Other limitations

This warranty is the complete and exclusive agreement between you and VTech. It supersedes all other written or oral communications related to this Product. VTech provides no other warranties for this Product. The warranty exclusively describes all of VTech's responsibilities regarding the Product. There are no other express warranties. No one is authorized to make modifications to this limited warranty and you should not rely on any such modification.

State/Provincial Law Rights: This warranty gives you specific legal rights, and you may also have other rights, which vary from state to state or province to province.

Limitations: Implied warranties, including those of fitness for a particular purpose and merchantability (an unwritten warranty that the Product is fit for ordinary use) are limited to one year from the date of purchase. Some states/provinces do not allow limitations on how long an implied warranty lasts, so the above limitation may not apply to you. In no event shall VTech be liable for any indirect, special, incidental, consequential, or similar damages (including, but not limited to lost profits or revenue, inability to use the Product or other associated equipment, the cost of substitute equipment, and claims by third parties) resulting from the use of this Product. Some states/provinces do not allow the exclusion or limitation of incidental or consequential damages, so the above limitation or exclusion may not apply to you.

Please retain your original sales receipt as proof of purchase.

Technical specifications

Frequency	2412 - 2462 MHz
Channels	11
Nominal effective range	Maximum power allowed by FCC and IC. Actual operating range may vary according to environmental conditions at the time of use.
Power requirements	Power adapter: Input: 100-120V AC 200mA 60Hz; Output: 6V DC 600mA

Credits:

The *Background Noise* sound file was created by Caroline Ford, and is used under the Creative Commons license.

The *Stream Noise* sound file was created by Caroline Ford, and is used under the Creative Commons license.

The *Crickets At Night* sound file was created by Mike Koenig, and is used under the Creative Commons license.

The *20121230_vacuum_cleaner.working.01.wav* sound file was created by dobroide, and is used under the Creative Commons license.

The *Heartbeat 5sec Int* sound file was created by Benboncan, and is used under the Creative Commons license.

The *junction_night_traffic.wav* sound file was created by ivolipa, and is used under the Creative Commons license.

The *SHHHH SHHH Shush sound* sound file was created by JohnsonBrandEditing, and is used under the Creative Commons license.

The *Washing Machine* sound file was created by nebulouslyllynn, and is used under the Creative Commons license.

The *Hairdryer.wav* sound file was created by ryanharding95, and is used under the Creative Commons license.

The *shower.mp3* sound file was created by geodylabs, and is used under the Creative Commons license.

The *Steady Rain.wav* sound file was created by pulswelle, and is used under the Creative Commons license.

The *In Car Driving.aif* sound file was created by RutgerMuller, and is used under the Creative Commons license.

The *fetal_doppler_stethoscope.wav* sound file was created by wjoojoo, and is used under the Creative Commons license.

The *HairDryer.wav* sound file was created by jakobhandersen, and is used under the Creative Commons license.

The *Fan.wav* sound file was created by Q.K., and is used under the Creative Commons license.

The *Waves.wav* sound file was created by juskiddink, and is used under the Creative Commons license.

The *birds3.aif* sound file was created by man, and is used under the Creative Commons license.

The *BIRDS* sound file was created by Julien Nicolas, and is used under the Creative Commons license.

The *train1.wav* sound file was created by mekoman, and is used under the Creative Commons license.

The *woman sexy shhh.wav* sound file was created by JanJanTO, and is used under the Creative Commons license.

Android® and *Google Play*® are registered trademarks of Google Inc.
App Store is a trademark of Apple Inc., registered in the U.S. and other countries.



Specifications are subject to change without notice.
© 2018 VTech Technologies Canada Ltd.
All rights reserved. 01/18. BC8312_CA_CIB_V1