

Go to www.vtechcanada.com to register your product for enhanced warranty support and the latest VTech product news.

CS5129 CS5129-25
CS5129-15 CS5129-26
CS5129-16 CS5129-3
CS5129-2 CS5129-4
CS5129-5
DECT 6.0 cordless telephone



vtech®

Abridged user's manual (Canada version)

Install the battery

Install the battery as shown below.



- Use only supplied battery.
- Charge the battery provided with this product only in accordance with the instructions and limitations specified in this manual.
- If the handset will not be used for a long time, disconnect and remove the battery to prevent possible leakage.

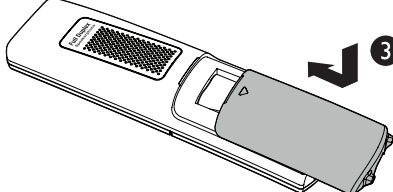
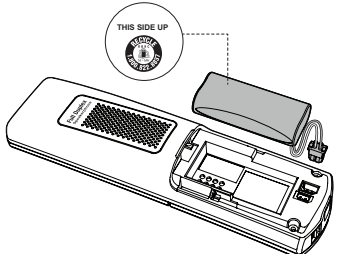
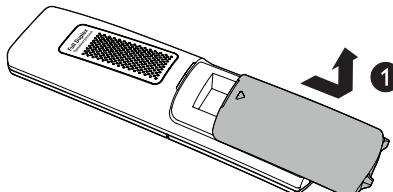

Check the battery level

After you have installed the battery, check the battery level on the handset screen.

- If the battery icon is or , then go to **Before use** section to set the date and time, and set the answering system through voice guide.
- If the screen is blank, or flashes, then the battery needs to be charged. Go to **Charge the battery** section before you do any setting or operation.

Congratulations

on purchasing your new VTech product. Before using this telephone, please read **Important safety instructions**.

This abridged user's manual provides you with basic installation and use instructions. A limited set of features are described in abbreviated form.

Please refer to the online user's manual for a full set of installation and operation instructions at www.vtechcanada.com.



Telephones identified with this logo have reduced noise and interference when used with most T-coil equipped hearing aids and cochlear implants. The TIA-1083 Compliant Logo is a trademark of the Telecommunications Industry Association. Used under license.



The ENERGY STAR® program (www.energystar.gov) recognizes and encourages the use of products that save energy and help protect our environment. We are proud to mark this product with the ENERGY STAR® label indicating it meets the latest energy efficiency guidelines.

What's in the box

Your telephone package contains the following items. Save your sales receipt and original packaging in the event warranty service is necessary.

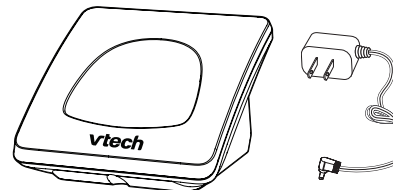
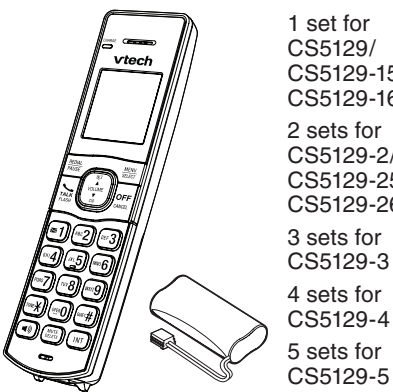
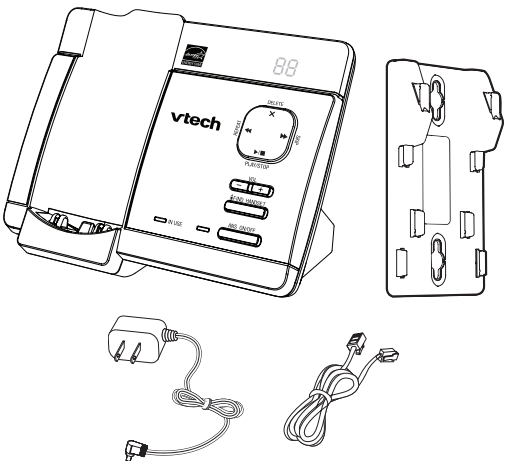

1 set for CS5129-2/CS5129-25/
CS5129-26
2 sets for CS5129-3
3 sets for CS5129-4
4 sets for CS5129-5

Telephone base overview

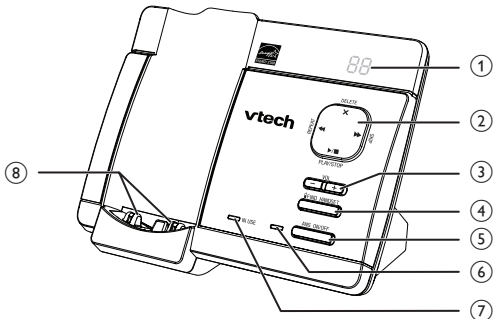

1 - Message window

2 - REPEAT

- Repeat a message.
- Press twice to play the previous message.

SKIP

- Skip to the next message.

DELETE

- Delete the playing message.
- Press twice to delete all old messages.

PLAY/STOP

- Play messages.
- Stop playing messages.

3 - VOL+

- Adjust the listening volume.
- Adjust the telephone base ringer volume.

4 - FIND HANDSET

- Page all system handsets.

5 - ANS ON/OFF

- Turn on or off the answering system.

6 - ANS ON/OFF light

- On if the answering system is on.

7 - IN USE light

- Flashes when there is an incoming call, or another telephone sharing the same line is in use.
- On when the telephone is in use, or the answering system is answering a call.

8 - Charging pole

Handset overview

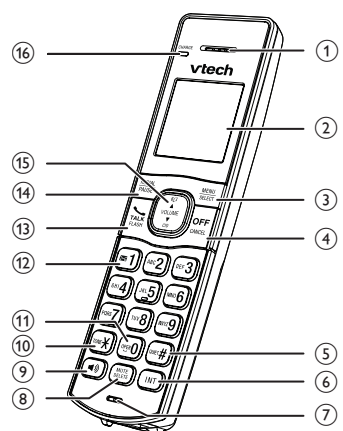

1 - Handset earpiece

2 - LCD display

3 - MENU/SELECT

- Show the menu.
- While in a menu, press to select an item, or save an entry or setting.

4 - OFF/CANCEL

- Hang up a call.
- Return to the previous menu or idle mode without making changes.
- Delete digits while predialing.
- Silence the handset ringer temporarily while the phone is ringing.
- Erase the missed call indicator while the handset is not in use.

5 - QUIET#

- Turn on or off the quiet mode.
- Show other dialing options when reviewing a caller ID log entry.

6 - INT

- Press to start an intercom conversation or transfer a call (for multi-handset models only).

7 - Microphone

8 - MUTE/DELETE

- Mute the microphone during a call.
- Silence the handset ringer temporarily while the phone is ringing.
- Delete the displayed entry while reviewing the phonebook, caller ID log, call block list or redial list.
- Delete digits or characters when entering numbers or names.

9 -

- Make or answer a call using the handset speakerphone.
- During a call, press to switch between the speakerphone and the handset earpiece.

10 - TONE

- Switch to tone dialing temporarily during a call.

11 - OPEN

- Press to add a space when entering names.

12 -

- Press repeatedly to add or remove 1 in front of the caller ID log entry before dialing or saving it to the phonebook.
- Press and hold to set or dial your voicemail number.

13 - TALK/FLASH

- Make or answer a call.
- Answer an incoming call when you receive a call waiting alert.

14 - REDIAL/PAUSE

- Review the redial list.
- Insert a dialing pause while dialing or entering numbers into the phonebook.

15 - VOLUME

- Review the phonebook when the phone is not in use.
- Scroll up while in a menu, or in the phonebook, caller ID log or redial list.
- Move the cursor to the right when entering numbers or names.
- Increase the listening volume during a call or message playback.
- Review the caller ID log when the telephone is not in use.
- Scroll down while in a menu, or in the phonebook, caller ID log or redial list.
- Move the cursor to the left when entering numbers or names.
- Decrease the listening volume during a call or message playback.

16 - CHARGE light

- On when the handset is charging.

Charger overview

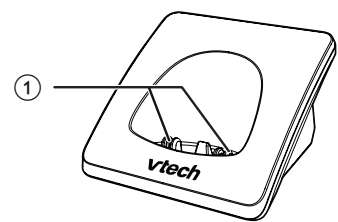

1 - Charging pole

Display icons overview

	The battery icon flashes when the battery is low and needs charging.
	The battery icon animates when the battery is charging.
	The battery icon becomes solid when the battery is fully charged.
	The handset ringer is turned off.
	There are new voicemail received from your telephone service provider.
NEW	There are new caller ID log entries.
ANS ON	The answering system is turned on.
1/13	The message number currently playing and total number of new/old messages recorded.
ECO	The ECO mode activates automatically to reduce power consumption when the handset is within range from the telephone base.

Connect

You can choose to connect the telephone base for desktop usage or wall mounting.

NOTES

- Use only the adapters provided.
- Make sure the electrical outlets are not controlled by wall switches.
- The adapters are intended to be correctly oriented in a vertical or floor mount position. The prongs are not designed to hold the plug in place if it is plugged into a ceiling, under-the-table or cabinet outlet.

TIP

- If you subscribe to digital subscriber line (DSL) high-speed Internet service through your telephone line, make sure you install a **DSL filter** (not included) between the telephone line cord and telephone wall jack. Contact your DSL service provider for more information.

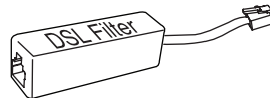

Connect the telephone base

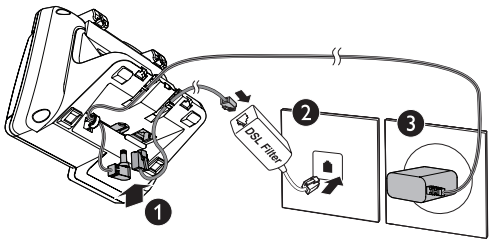

Connect the charger

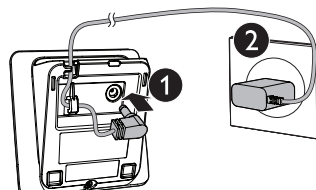

Mount the telephone base

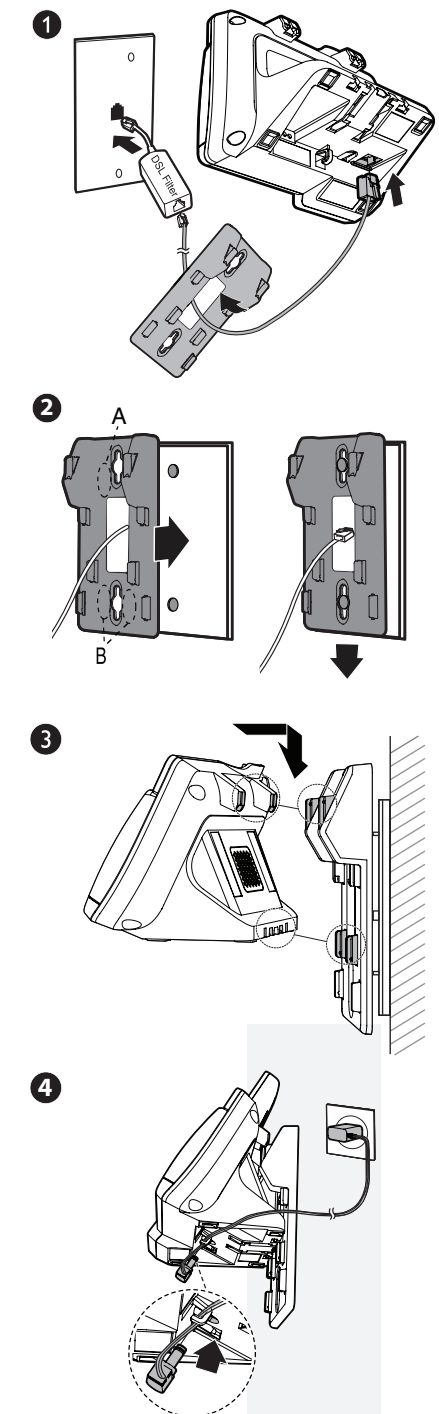

Charge the battery

Charge the battery

Place the handset in the telephone base or the charger to charge.

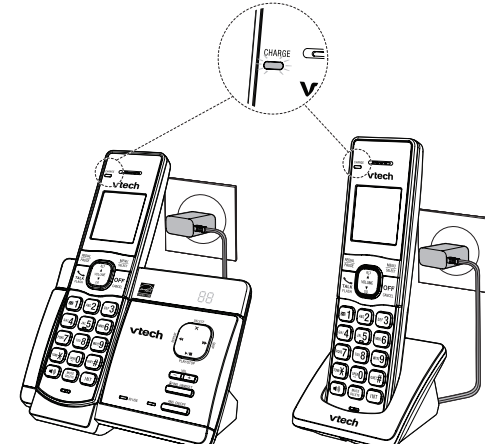

Once you have installed the battery, the handset LCD display indicates the battery status (see the table below).

NOTES

- Press **CANCEL** or place the handset in the charger will bypass the set date and time, and voice guide.
- For best performance, keep the handset in the telephone base or charger when not in use.
- The battery is fully charged after 12 hours of continuous charging.
- If you place the handset in the telephone base or the charger without plugging in the battery, the screen displays **No battery**.

Battery indicators	Battery status	Action
The screen is blank, or displays Put in charger and flashes.	The battery has no or very little charge. The handset cannot be used.	Charge without interruption (at least 30 minutes).
The screen displays Low battery and flashes.	The battery has enough charge to be used for a short time.	Charge without interruption (about 30 minutes).
The screen displays HANDSET X .	The battery is charged.	To keep the battery charged, place it in the telephone base or charger when not in use.

To manually set the date and time and the answering system, refer to **Configure your telephone** and **Set your built-in answering system** sections.

To manually initiate the voice guide, refer to **Voice guide** under **Set your built-in answering system** section.

Before use

After you install your telephone or power returns following a power outage and battery depletion, the handset will prompt you to set the date and time, and the answering system through voice guide.

Set date and time

NOTE

- Make sure you set the date and time including the year correctly; otherwise the answering system does not announce the correct day of the week for your recorded messages time stamp.

1. Use the dialing keys (0-9) to enter the month (MM), date (DD) and year (YY). Then press **SELECT**.
2. Use the dialing keys (0-9) to enter the hour (HH) and minute (MM). Then press **▼** or **▲** to choose **AM** or **PM**.
3. Press **SELECT** to save.

After the setting for the date and time, the handset will display **Voice guide to...** and set up **Ans sys?** alternatively.

Set answering system through voice guide

This feature assists you to do the basic setup of the answering system. You can follow the voice guide to record your own announcement, set the number of rings and the message alert tone.

1. Press **SELECT** to start the voice guide for the answering system setup. You hear the voice prompt "Hello! This voice guide will assist you with the basic setup of your answering system."
2. Setup your answering system by inputting the designated numbers as instructed in the voice guide.

Check for dial tone

Press **TALK**. If you hear a dial tone, the installation is successful.

If you do not hear a dial tone:

- Make sure the installation procedures described above are properly done.
- It may be a wiring problem. If you have changed your telephone service to digital service from a cable company or a VoIP service provider, the telephone line may need to be rewired to allow all existing telephone jacks to work. Contact your cable/VoIP service provider for more information.

Operating range

This cordless telephone operates with the maximum power allowed by the Federal Communications Commission (FCC). Even so, this handset and telephone base can communicate over only a certain distance - which can vary with the locations of the telephone base and handset, the weather, and the layout of your home or office.

When the handset is out of range, the handset displays **Out of range or no pwr at base**.

If there is a call while the handset is out of range, it may not ring, or if it does ring, the call may not connect well when you press **TALK**. Move closer to the telephone base, then press **TALK** to answer the call. If the handset moves out of range during a telephone conversation, there may be interference. To improve reception, move closer to the telephone base.

Use the handset menu

1. Press **MENU** when the phone is not in use.
2. Press **▼** or **▲** until the screen displays the desired feature menu.
3. Press **SELECT**.
- To return to the previous menu, press **CANCEL**.
- To return to idle mode, press and hold **CANCEL**.

Configure your telephone

Set language

The LCD language is preset to English. You can select English, French or Spanish to be used in all screen displays.

1. Press **MENU** when the handset is not in use.
2. Scroll to **Settings**, then press **SELECT** twice.
3. Scroll to choose **English**, **Français** or **Español**.
4. Press **SELECT** to save your setting.

Set date and time

NOTE

- Make sure you set the date and time including the year correctly; otherwise the answering system does not announce the correct day of the week for your recorded messages time stamp.

1. Press **MENU** on the handset when not in use.
2. Scroll to **Set date/time** and then press **SELECT**.
3. Use the dialing keys (0-9) to enter the month (MM), date (DD) and year (YY). Then press **SELECT**.
4. Use the dialing keys (0-9) to enter the hour (HH) and minute (MM). Then press **▼** or **▲** to choose **AM** or **PM**.
5. Press **SELECT**.

Temporary tone dialing

If you have pulse (rotary) service only, you can switch from pulse to touch-tone dialing temporarily during a call.

1. During a call, press **TONE**.
2. Use the dialing keys to enter the relevant number. The telephone sends touch-tone signals. It automatically returns to pulse dialing mode after you end the call.

Telephone operations

Handset control key panel:

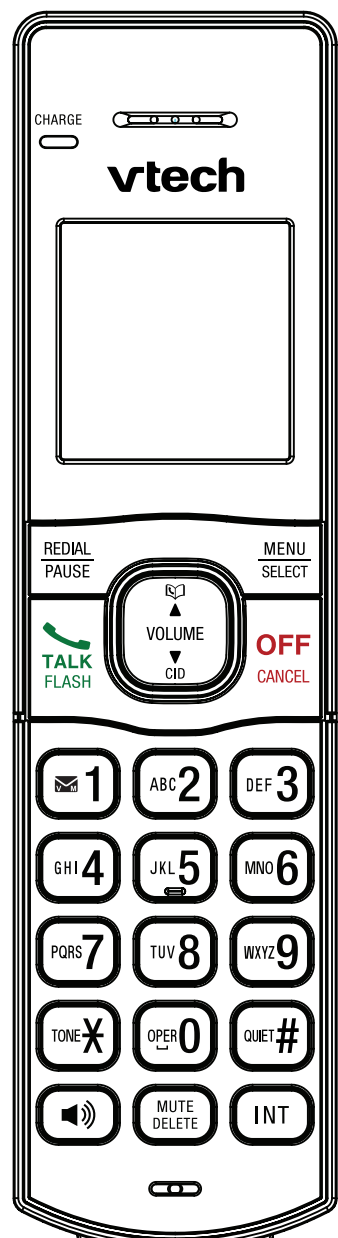

Make a call

- Press **TALK** or **▲**, and then dial the telephone number.

Answer a call

- Press **TALK**, **▲** or any of the dialing keys.

End a call

- Press **OFF** or put the handset back in the telephone base or charger.

Speakerphone

- During a call, press **▲** on the handset to switch between speakerphone and handset earpiece.

Volume

- During a call, press **▲**/VOLUME/▼ to adjust the listening volume.

Mute

The mute function allows you to hear the other party but the other party cannot hear you.

1. During a call, press **MUTE**. The handset displays **Muted**.
2. Press **MUTE** again to resume the conversation. The handset displays **Microphone** on briefly.

Join a call in progress (for multiple handset models only)

You can use up to four handsets at a time on an outside call.

- When a handset is already on a call, press **TALK** or **▲** on another handset to join the call.
- To exit the call, press **OFF** on the handset or place it in the telephone base or charger. The call continues until all handsets hang up.

Call waiting

When you subscribe to call waiting service from your telephone service provider, you hear an alert tone if there is an incoming call while you are already on a call.

- Press **FLASH** to put the current call on hold and take the new call.
- Press **FLASH** at any time to switch back and forth between calls.

Find handset

Use this feature to find the system handset.

To start paging:

- Press **FIND HANDSET** on the telephone base when not in use. All idle handsets ring and display **** Paging ****.

To end paging:

- Press **FIND HANDSET** at the telephone base.

-OR-

- Press **TALK**, **▲** or any of the dialing keys on the handset.

-OR-

- Place the handset in the telephone base or charger.

NOTE

- Do not press and hold **FIND HANDSET** for more than four seconds. It may lead to handset deregistration.

Redial list

Each handset stores the last 10 telephone numbers dialed. When there are already 10 entries, the oldest entry is deleted to make room for the new entry.

Review and dial a redial list entry

1. Press **REDIAL** when the handset is not in use.
2. Press **▼**, **▲** or **REDIAL** repeatedly until the desired entry displays.
3. Press **TALK** to dial.

Delete a redial list entry

- When the desired redial entry displays, press **DELETE**.

Intercom

Use the intercom features for conversations between two handsets.

1. Press **INT** on your handset when not in use. Use the dialing keys to enter a destination handset number if necessary.
2. To answer the intercom call, press **TALK**, **▲**, **INT** or any dialing key on the destination handset.
3. To end the intercom call, press **OFF** or place the handset back in the telephone base or charger.

Answer an incoming call during an intercom call

If you receive an incoming call during an intercom call, there is an alert tone.

- To answer the outside call, press **TALK**. The intercom call ends automatically.
- To end the intercom call without answering the outside call, press **OFF**. The telephone continues to ring.

Transfer a call

While on an outside call, you can use the intercom feature to transfer the call from one handset to another.

1. Press **INT** on your handset during a call. The current call is put on hold. Use the dialing keys to enter a destination handset number if necessary.
2. To answer the intercom call, press **TALK**, **▲**, or any dialing key on the destination handset. You can now have a private conversation before transferring the call.
3. Press **OFF** on your originating handset, or place it back in the telephone base or charger. Your originating handset displays **Line in use**. The destination handset is then connected to the outside call.

Phonebook

The phonebook can store up to 50 entries, which are shared by all handsets. Each entry may consist of a telephone number up to 30 digits, and a name up to 15 characters.

Add a phonebook entry

1. Enter the number when the phone is not in use. Press **MENU**, then go to Step 3.

-OR-

Press **MENU** when the phone is not in use, then press **▼** or **▲** to scroll to **Phonebook**. Press **SELECT** twice to choose **Add new entry**.

2. Use the dialing keys to enter the number.

-OR-

Copy a number from the redial list by pressing **REDIAL** and then press **▼**, **▲** or **REDIAL** repeatedly to select a number. Press **SELECT** to copy the number.

3. Press **SELECT** to move on to enter the name.
4. Use the dialing keys to enter the name. Additional key presses show other characters of that particular key.
5. Press **SELECT** to save.

While entering names and numbers, you can:

- Press **DELETE** to backspace and erase a digit or character.
- Press and hold **DELETE** to erase the entire entry.
- Press **▼** or **▲** to move the cursor to the left or right.
- Press and hold **PAUSE** to insert a dialing pause (for entering numbers only).
- Press 0 to add a space (for entering names only).

Review a phonebook entry

Entries are sorted alphabetically.

1. Press **INT</**

Dial a caller ID log entry

- When the desired entry appears, press **CALL** or **END** to dial.

Save a caller ID log entry to the phonebook

- When the desired caller ID log entry displays, press **SELECT**.
- Press **SELECT** to choose **To Phonebook**.
- Use the dialing keys to edit the number, if necessary. Then press **SELECT**.
- Use the dialing keys to edit the name, if necessary. Then press **SELECT**.

Delete the caller ID log entries

- When the desired caller ID log entry displays, press **DELETE**.

To delete all caller ID log entries:

- Press **MENU** when the phone is not in use.
- Scroll to **Caller ID log** and then press **SELECT**.
- Scroll to **Delete all** then press **SELECT** twice.

Call block

If you have subscribed to caller ID service, you can set the telephone to block unknown calls and certain undesired calls. The call block list can store up to 20 entries.

Block unknown calls

- Press **MENU** when the handset is not in use.
- Scroll to **Call block** and then press **SELECT**.
- Scroll to choose **Calls w/o num**, and then press **SELECT**.
- Scroll to choose **Unblock** or **Block**, and then press **SELECT** to save.

Add a call block list entry

- Press **MENU** when the handset is not in use.
- Scroll to **Call block** and then press **SELECT**.
- Press **SELECT** to choose **Block list**.
- Scroll to choose **Add new entry**, and then press **SELECT**.
- Use the dialing keys to enter the number (up to 30 digits).
- Press **SELECT** to move on to enter the name.
- Use the dialing keys to enter the name (up to 15 characters). Additional key presses show other characters of that particular key.
- Press **SELECT** to save.

Review call block list

- Press **MENU** when the handset is not in use.
- Scroll to **Call block** and then press **SELECT**.
- Press **SELECT** to choose **Block list**.
- Press **SELECT** to choose **Review**.

Edit a call block list entry

- When the desired entry displays, press **SELECT**.
- Use the dialing keys to edit the number, and then press **SELECT**.
- Use the dialing keys to edit the name, and then press **SELECT** to save.

Save a caller ID log entry to call block list

- When the desired caller ID log entry displays, press **SELECT**.
- Scroll to **To Call block**, and then press **SELECT**.
- Use the dialing keys to edit the number, and then press **SELECT**.
- Use the dialing keys to edit the name, and then press **SELECT** to save.

Delete a call block list entry

- When the desired call block list entry displays, press **DELETE**.

Mute first ring

Your telephone rings once for blocked calls. You can choose to mute the first ring for all incoming calls, so that there will be no ring for blocked calls. By default, the first ring is set to **On**.

- Press **MENU** when the handset is not in use.
- Press **7464** on the handset.
- Press **▼** or **▲** to choose **First ring:On** to keep the first ring, or **First ring:Off** to mute the first ring.
- Press **SELECT** to save.

NOTE

- If you have muted the first ring, you will hear one ring less before the answering system and voicemail answer the incoming calls.

Sound settings

Key tone

You can turn the key tone on or off.

- Press **MENU** when the handset is not in use.
- Scroll to **Settings** and then press **SELECT**.
- Scroll to choose **Key tone**, then press **SELECT**.
- Press **▼** or **▲** to choose **On** or **Off**, then press **SELECT** to save.

Ringer tone

You can choose from different ringer tones for each handset.

- Press **MENU** when the handset is not in use.
- Scroll to **Ringers** and then press **SELECT**.
- Scroll to choose **Ringer tone**, then press **SELECT**.

- Press **▼** or **▲** to sample each ringer tone, then press **SELECT** to save.

NOTE

- If you turn off the ringer volume, you will not hear ringer tone samples.

Telephone base ringer volume

Press **—VOL+** on the telephone base to adjust the ringer volume when the telephone base is not in use.

When you set the ringer volume to zero, the base ringer is off. The telephone base announces, *"Base ringer is off."*

Handset ringer volume

You can adjust the handset ringer volume level, or turn the ringer off.

- Press **MENU** when the handset is not in use.
- Scroll to **Ringers** and then press **SELECT** twice.
- Press **▼** or **▲** to sample each volume level, then press **SELECT** to save.

NOTE

When the ringer volume is set to Off, the handset still rings when you press **FIND HANSET** at the telephone base.

Temporary ringer silencing

When the telephone is ringing, you can temporarily silence the ringer without disconnecting the call. The next call rings normally at the preset volume.

To silence the handset ringer:

- Press **CANCEL** or **MUTE**. The handset displays **Ringer muted** and .

To silence the telephone base ringer:

- Press **—VOL**.

Quiet mode

You can turn on the quiet mode for a period of time. During this period, all tones (except paging tone) and call screening are muted. When you turn on the quiet mode, the answering system turns on automatically.

- Press and hold **QUIET#** on the handset when idle.
- Use the dialing keys to enter the duration, and then press **SELECT** to save.

- To turn off the quiet mode, press and hold **QUIET#** on the handset when idle.

About the built-in answering system and voicemail service

For message recording, your telephone has a built-in answering system, and it also supports voicemail service offered by your telephone service provider (subscription is required, and fee may apply).

The main differences between them are:

Category	Built-in answering system	Voicemail from telephone service
Storage	Messages are stored in the telephone base.	Messages are stored in a server or system provided by your telephone service provider.
	Your messages will not be deleted automatically. You have to delete your messages manually.	Your messages may be automatically deleted after a period of time. Contact your telephone service provider for more details.
Method to retrieve messages	When you received new messages, the handset displays XX new messages , and the message window on the telephone base flashes.	When you received new messages, the handset displays ✉ and New voicemail .
	To retrieve messages, usually there are two ways: <ul style="list-style-type: none">Press ►/■ on the telephone base; orAccess remotely with an access code.	To retrieve messages, you need an access number and/or a passcode provided by your telephone service provider.

Set your built-in answering system

The answering system can record and store up to 99 messages. Each message can be up to three minutes in length. The total storage capacity for the announcement, messages and memos is approximately 23 minutes. The actual recording time depends on individual message characteristics.

Your answering system allows you to set your announcement, to save and delete messages, activate call screening, to set number of rings before pick up, and to access remotely.

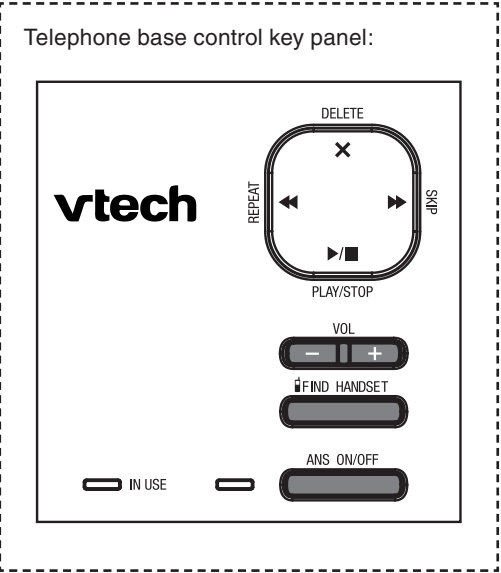

Turn the answering system on or off

The answering system must be turned on to answer and record messages.

To turn on or off with the telephone base:

- Press **ANS ON/OFF** to turn the built-in answering system on or off.

To turn on or off with the handset:

- Press **MENU** when the phone is not in use.
- Scroll to **Answering sys** and then press **SELECT**.
- Scroll to **Answer on/off** and then press **SELECT**.
- Press **▼** or **▲** to choose **On** or **Off** and then press **SELECT**.

Default announcement

The telephone is preset with a greeting that answers calls with *"Hello, please leave a message after the tone."* You can use this preset announcement, or replace it with your own.

Record your own announcement

The announcement can be up to 90 seconds in length.

- Press **MENU** when the phone is not in use.
- Scroll to **Answering sys** then press **SELECT** twice.
- The handset announces, *"To play, press 2. To record, press 7."* Then press 7 to record.
- The handset announces, *"Record after the tone. Press 5 when you are done."* After the tone, speak towards the handset microphone.
- Press 5 when done.

Play the announcement

- Press **MENU** when the phone is not in use.
- Scroll to **Answering sys** then press **SELECT** twice.
- The handset announces, *"To play, press 2. To record, press 7."* Then press 2 to play the current announcement.

Options during playback:

- Press **▲/VOLUME/▼** to adjust the listening volume.
- Press 5 or OFF to stop at any time.

Delete the announcement

- Press **MENU** when the phone is not in use.
- Scroll to **Answering sys** then press **SELECT** twice.
- The handset announces, *"To play, press 2. To record, press 7."* Then press 3 to delete your own recorded announcement.

NOTE

- After you deleted your own recorded announcement, the answering system answers calls with the default announcement.

Set number of rings

You can set the answering system to answer an incoming call after two, three, four, five or six rings; or toll saver. If you choose toll saver, the answering system answers a call after two rings when you have new messages, or after four rings when you have no new messages.

- Press **MENU** when the phone is not in use.
- Scroll to **Answering sys** and then press **SELECT**.
- Scroll to **Ans sys setup** and then press **SELECT**.
- Scroll to **# of rings** and then press **SELECT**.
- Press **▼** or **▲** to choose **6**, **5**, **4**, **3** or **Toll saver** and then press **SELECT**.

NOTE

- If you have muted the first ring, you will hear one ring less before the answering system answers the incoming calls.

Set message alert tone

When the message alert tone is set to on, and there is at least one new message, the telephone base beeps every 10 seconds. The message alert tone is preset to off.

- Press **MENU** when the phone is not in use.
- Scroll to **Answering sys** and then press **SELECT**.
- Scroll to **Ans sys setup** and then press **SELECT**.
- Scroll to **Msg alert tone** and then press **SELECT**.
- Press **▼** or **▲** to choose **On** or **Off** and then press **SELECT**.

Voice guide

This feature is an alternative way for you to do the basic setup of the answering system. You can follow the voice guide to record your own announcement, set the number of rings and the message alert tone.

- Press **MENU** when the phone is not in use.
- Scroll to **Answering sys** and then press **SELECT**.
- Scroll to **Voice guide** and then press **SELECT**. You will hear the voice prompt *"Hello! This voice guide will assist you with the basic setup of your answering system."*
- Setup your answering system by inputting designated numbers as instructed in the voice guide.

Use your built-in answering system

New message indication

When there are new answering system messages, the handset displays **XX new messages**, and the message window on the telephone base flashes.

If the message alert tone is turned on, the telephone base beeps every 10 seconds when there are messages that have not been reviewed.

Message playback

To playback messages at the telephone base:

- Press **►/■** when the phone is not in use.

Options during playback:

- Press **—VOL+** to adjust the listening volume.
- Press **►/SKIP** to skip to the next message.
- Press **◄/REPEAT** to repeat the playing message. Press **◄/REPEAT** twice to listen to the previous message.
- Press **X/DELETE** to delete the playing message. The system advances to the next message.
- Press **►/STOP** to stop.

To playback messages with a handset:

- Press **MENU** when the phone is not in use, and then press **SELECT**.

Options during playback:

- Press **▲/VOLUME/▼** to adjust the listening volume.
- Press 6 to skip to the next message.
- Press 4 to repeat the playing message. Press 4 twice to listen to the previous message.
- Press 3 to delete the playing message. The system advances to the next message.
- Press **OFF** to stop the playback.

Delete all messages

You can only delete old (reviewed) messages. You cannot delete new messages until you review them. You cannot retrieve deleted messages.

To delete all messages with the telephone base:

- Press **X/DELETE** twice when the phone is not in use.

To delete all messages with a handset:

- Press **MENU** when the phone is not in use.
- Scroll to **Answering sys** and then press **SELECT**.
- Scroll to **Delete all old** and then press **SELECT**.

Remote access

A two-digit security code is required to access the answering system remotely from any touch-tone telephone. The preset code is **19**. You can use this preset code, or set your own.

- Dial your telephone number from any touch-tone telephone.
- When the system plays your announcement, enter the two-digit security code.
- Enter one of the following remote commands.

Command	Description
1	Play all messages.
2	Play only new messages.
3	Delete the current message (during playback).
33	Delete all old messages.
4	Repeat the current message (during playback).
5	Stop.
*5	Hear a list of remote commands.
6	Skip to the next message (during playback).
*7	Record a new announcement.
8	End the call.
0	Turn the answering system on or off.

- Hang up or press 8 to end the call.

Remote access code

You can set your own remote access code from **00 to 99**.

- Press **MENU** when the phone is not in use.
- Scroll to **Answering sys** then press **SELECT**.
- Scroll to **Ans sys setup** and then press **SELECT**.
- Scroll to **Remote code** and then press **SELECT**.
- Press the dialing keys (0-9) to enter the code, or **▲** to select from **00 to 99**, then press **SELECT**.

NOTE

- This feature turns off the indicators only, it does not delete your voicemail messages.

- Press **MENU** when the phone is not in use.
- Scroll to **Settings** and then press **SELECT**.
- Scroll to **Clr voicemail** and then press **SELECT**.

Expand your telephone system

You can add new handsets (**CS5109**), cordless headsets (**IS6200**) or speakerphones (**MA3222** or **AT1180133**) to your telephone system. All accessories are sold separately. Your telephone base supports a maximum of five devices.

For more details, refer to the user's manual that comes with your new device.

ECO mode

This power conserving technology reduces power consumption for optimal battery performance. The ECO mode activates automatically whenever the handset is synchronized with the telephone base.

General product care

Taking care of your telephone

Your cordless telephone contains sophisticated electronic parts, so it must be treated with care.

Avoid rough treatment

Place the handset down gently. Save the original packing materials to protect your telephone if you ever need to ship it.

Avoid water

Your telephone can be damaged if it gets wet. Do not use the handset outdoors in the rain, or handle it with wet hands. Do not install the telephone base near a sink, bathtub or shower.

Electrical storms

Electrical storms can sometimes cause power surges harmful to electronic equipment. For your own safety, take caution when using electrical appliances during storms.

Cleaning your telephone

Your telephone has a durable plastic casing that should retain its luster for many years. Clean it only with a dry non-abrasive cloth. Do not use dampened cloth or cleaning solvents of any kind.

Frequently asked questions

Below are the questions most frequently asked about the cordless telephone. If you cannot find the answer to your question, visit our website at www.vtechcanada.com or call 1 (800) 267-7377.

My telephone does not work at all.	Make sure the telephone base is installed properly, and battery is installed and charged correctly. For optimum daily performance, turn the handset to the telephone base after use.
The display shows No line . I cannot hear the dial tone.	Disconnect the telephone line cord from your telephone and connect it to another telephone. If there is no dial tone on that other telephone either, then the telephone line cord may be defective. Try installing a new telephone line cord. If changing the telephone line cord does not help, the wall jack (or the wiring to this wall jack) may be defective. Contact your telephone service provider.
You may be using a new cable or VoIP service, the existing telephone jacks in your home may no longer work. Contact your service provider for solutions.	
The handset is deregistered from the telephone base. Place the handset in the telephone base to register it. You hear a beep when the registration process completes. This process takes about 60 seconds.	The handset is deregistered from the telephone base. Place the handset in the telephone base to register it. You hear a beep when the registration process completes. This process takes about 60 seconds.
The display shows HS... and ...see manual alternately. The handset does not work at all.	Make sure the answering system is on. When the answering system is on, ANS should display on the handset and the telephone base.
The answering system does not record messages.	When the answering machine memory is full, it does not record new messages until some old messages are deleted.
If you subscribe to voicemail service, change the number of rings so that your answering system answers before your voicemail service answers. To determine how many rings activate your voicemail service, contact your telephone service provider.	If you subscribe to voicemail service, change the number of rings so that your answering system answers before your voicemail service answers. To determine how many rings activate your voicemail service, contact your telephone service provider.

The answering system does not announce the correct day of the week for recorded messages time stamp.	Make sure you have set the date and time. See Configure your telephone section.
The messages on the answering system are incomplete.	The maximum length for a message is three minutes. The caller leaves a long message, i.e., more than three minutes, part of it may be lost when the answering system disconnects the call.
If the memory on the answering system becomes full during a message, the answering system stops recording and disconnects the call.	If the memory on the answering system becomes full during a message, the answering system stops recording and disconnects the call.
I accidentally set my LCD language to Spanish or French, and I don't know how to change it back to English.	While the handset is not in use, press MENU and then enter the number to change the handset LCD language back to English.
Important safety instructions	
When using your telephone equipment, basic safety precautions should always be followed to reduce the risk of fire, electric shock and injury, including the following:	
1. Read and understand all instructions.	
2. Follow all warnings and instructions marked on the product.	
3. Unplug this product from the wall outlet before cleaning. Do not use liquid or aerosol cleaners. Use a damp cloth for cleaning.	
4. Do not use this product near water such as near a bath tub, wash bowl, kitchen sink, laundry tub or swimming pool, or in a wet basement or shower.	
5. Do not place this product on an unstable table, shelf, stand or other unstable surface.	
6. Avoid placing the telephone system in places with extreme temperature, direct sunlight, or other electrical devices. Protect your phone from moisture, dust, corrosive liquids and fumes.	
7. Slots and openings in the back or bottom of the telephone base and handset are provided for ventilation. To protect them from overheating, these openings must not be blocked by placing the product on a soft surface such as a bed, sofa or rug. This product should never be placed near a radiator or heat register. This product should not be placed in any area where proper ventilation is not provided.	
8. This product should be operated only from the type of power source indicated on the marking label. If you are not sure of the type of power supply in your home or office, consult your dealer or local power company.	
9. Do not allow anything to rest on the power cord. Do not install this product where the cord may	

- be walked on.
- Never push objects of any kind into this product. Do not use the slots in the telephone base or handset because they may touch dangerous voltage points or create a short circuit. Never spill liquid of any kind on the product.
- To reduce the risk of electric shock, do not disassemble this product, but take it to an authorized service facility. Opening or removing parts of the telephone base or handset other than specified access doors may expose you to dangerous voltages or other risks. Incorrect assembling can cause electric shock when the product is subsequently used.
- Do not overload wall outlets and extension cords.
- Unplug this product from the wall outlet and refer servicing to an authorized service facility under the following conditions:
 - When the power supply cord or plug is damaged or frayed.
 - If liquid has been spilled onto the product.
 - If the product has been exposed to rain or water.
 - If the product does not operate normally by following the operating instructions. Adjust only those controls that are covered by the operation instructions. Improper adjustment of other controls may result in damage and often requires extensive work by an authorized technician to restore the product to normal operation.
 - If the product has been dropped and the telephone base and/or handset has been damaged.
 - If the product exhibits a distinct change in performance.
- Avoid using a telephone (other than cordless) during an electrical storm. There is a remote risk of electric shock from lightning.
- Do not use the telephone to report a gas leak in the vicinity of the leak. Under certain circumstances, a spark may be created when the adapter is plugged into the power outlet, or when the handset is replaced in its cradle. This is a common event associated with the closing of any electrical circuit. The user should not plug the phone into a power outlet, and should not put a charged handset into the cradle, if the phone is located in an environment containing concentrations of flammable or flammable-supporting gases. If there is adequate ventilation. A spark in such an environment could create a fire or explosion. Such environments might include: medical use of oxygen without adequate ventilation; industrial gases (cleaning solvents; gasoline vapors; etc.); a leak of natural gas; etc.
- Only put the handset of your telephone next to your ear when it is in normal talk mode.
- The power adapters are intended to be correctly oriented in a vertical or floor mount position. The prongs are not designed to hold the plug in place if it is plugged into a ceiling, under-the-table or cabinet outlet.
- This product should be operated only from the type of power source indicated on the marking label. If you are not sure of the type of power supply in your home or office, consult your dealer or local power company.
- Do not allow anything to rest on the power cord. Do not install this product where the cord may

- Battery**
 - CAUTION:** Use Only Supplied Battery.
 - Do not dispose of the battery in a fire. Check with local waste management codes for special disposal instructions.
 - Do not open or mutilate the battery. Released electrolyte is corrosive and may cause burns or injury to the eyes or skin. The electrolyte may be toxic if swallowed.
 - Exercise care in handling batteries in order not to create a short circuit with conductive materials.
 - Charge the battery provided with or identified for use with this product only in accordance with the instructions and limitations specified in this manual.
- Precautions for users of implanted cardiac pacemakers**

Cardiac pacemakers (applies only to digital cordless telephones):

 - Wireless Technology Research, LLC (WTR), an independent research entity, led a multidisciplinary evaluation of the interference between portable wireless telephones and implanted cardiac pacemakers. Supported by the U.S. Food and Drug Administration, WTR recommends to physicians that:
- Pacemaker patients**
 - Should keep wireless telephones at least six inches from the pacemaker.
 - Should NOT place wireless telephones directly over the pacemaker, such as in a breast pocket, when it is turned ON.
 - Should use the wireless telephone at the ear opposite the pacemaker.
- WTR's evaluation did not identify any risk to bystanders with pacemakers from other persons using wireless telephones.
- About cordless telephones**
 - Privacy:** The same features that make a cordless telephone convenient create some limitations. Telephone calls are transmitted between the telephone base and the cordless handset by radio waves, so there is a possibility that the cordless telephone conversations could be intercepted by radio receiving equipment within range of the cordless handset. To this end, we do not think of cordless telephone conversations as being as private as those on corded telephones.
 - Electrical power:** The telephone base of this cordless telephone must be connected to a working electrical outlet. The electrical outlet should not be controlled by a wall switch. Calls cannot be made from the cordless handset if the telephone base is unplugged, switched off or if the electrical power is interrupted.
 - Potential TV interference:** Some cordless telephones operate at frequencies that may cause interference to televisions and VCRs. To minimize or prevent such interference, do not place the telephone base of the cordless telephone near or