

Go to [www.vtechphones.com](http://www.vtechphones.com) (US) to register your product for enhanced warranty support and latest VTech product news.

Go to [phones.vtechcanada.com](http://phones.vtechcanada.com) (CA) for latest VTech product news.

CS5329  
CS5329-2  
CS5329-3  
CS5329-4

DECT 6.0 cordless telephone

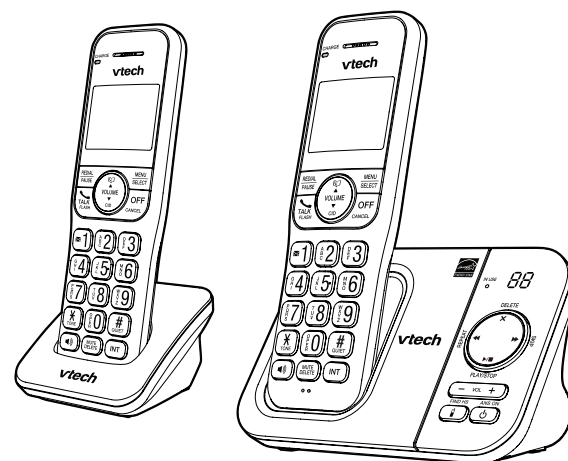

Scan the QR code for support information



**vtech**  
Quick start guide

Specifications are subject to change without notice.  
© 2023 Vtech Communications, Inc.  
2023 Vtech Technology Canada Ltd.  
All rights reserved. 01/23, CS5329-X, 05G, US-CA-V2

**DISCLAIMER AND LIMITATION OF LIABILITY**  
Vtech Communications, Inc. and its suppliers assume no responsibility for any damage or loss resulting from the use of this product. Vtech Communications, Inc. and its suppliers assume no responsibility for any loss or claims by third parties that may arise through the use of this product.  
Address: 9020 SW Washington Square Road - Ste 555 Tigard, OR 97223, United States  
Phone: 1 (800) 595-9511 in the U.S. or 1 (800) 267-7377 in Canada

**ENERGY STAR**  
The ENERGY STAR program (www.energystar.gov) recognizes and encourages the use of products that save energy and help protect our environment. We are proud to mark this product with the ENERGY STAR label indicating it meets the latest energy efficiency guidelines.

**TECHNICAL SPECIFICATIONS**

Frequency control	Crystal controlled PLL synthesizer
Transmit frequency	Handset: 1921.536-1928.448 MHz Telephone base: 1921.536-1928.448 MHz
Channels	DECT channel: 5
Normal effective range	Maximum power allowed by FCC and IC. Actual operating range may vary according to environmental conditions at the time of use.
Power requirement	Handset: 2.4V Ni-MH battery Telephone base: 6V DC @ 0.4A Charger: 6V DC @ 0.4A
Memory	Phonebook: 50 memory locations Caller ID log: 30 memory locations up to 24 digits and 15 characters Call block: 150 entries

## IMPORTANT SAFETY INSTRUCTIONS

- When using your telephone equipment, basic safety precautions should always be followed to reduce the risk of fire, electric shock and injury, including the following:
- Read and understand all instructions.
  - Follow all warnings and instructions marked on the product.
  - Unplug this product from the wall outlet before cleaning. Do not use liquid or aerosol cleaners. Use a damp cloth for cleaning.
  - CAUTION:** Do not install the telephone base at a height above 2 meters.
  - Do not use this product near water such as near a bath tub, wash bowl, kitchen sink, laundry tub or a swimming pool, not in a wet basement or shower.
  - Do not place this product on an unstable table, shelf, stand or other unstable surfaces.
  - Avoid placing the telephone system in places with extreme temperature, direct sunlight, or other electrical devices. Protect your phone from moisture, dust, corrosive liquids and fumes.
  - Slots and openings in the back or bottom of the telephone base and handset are provided for ventilation. To protect them from overheating, these openings must not be blocked by placing the product on a soft surface such as a bed, sofa or rug. This product should never be placed near or over a radiator or heat register. This product should not be placed in any area where proper ventilation is not provided.
  - This product should be operated only from the type of power source indicated on the marking label. If you are not sure of the type of power supply in your home or office, consult your dealer or local power company.
  - Do not allow anything to rest on the power cord. Do not install this product where the cord may be walked on.
  - Never push objects of any kind into this product through the slots in the telephone base or handset because they may touch dangerous voltage points or create a short circuit. Never spill liquid of any kind on the product.
  - To reduce the risk of electric shock, do not disassemble this product, and take it to an authorized service facility. Opening or removing parts of the telephone base or handset other than those specified access doors may expose you to dangerous voltages or other risks. Incorrect reassembling can cause electric shock when the product is subsequently used.
  - Do not overload wall outlets and extension cords.
  - Unplug this product from the wall outlet

- and refer servicing to an authorized service facility under the following conditions:
- When the power supply cord or plug is damaged or frayed.
  - If liquid has been spilled onto the product.
  - If the product has been exposed to rain or water.
  - If the product does not operate normally by following the operating instructions. Adjust only those controls that are covered by the operation instructions. Improper adjustment of other controls may result in damage and often requires extensive work by an authorized technician to restore the product to normal operation.
  - If the product has been dropped and the telephone base and/or handset has been damaged.
  - If the product exhibits a distinct change in performance.
- Avoid using a telephone (other than cordless) during an electrical storm. There is a remote risk of electric shock from lightning.
  - Do not use the telephone to report a gas leak in the vicinity of the leak. Under certain circumstances, a spark may be created when the adapter is plugged into the power outlet, or when the handset is replaced in its cradle. This is a common event associated with the closing of any electrical circuit. The user should not plug the phone into a power outlet, and should not put a charged handset into the cradle, if the phone is located in an environment containing concentrations of flammable or flame-supporting gases, unless there is adequate ventilation. A spark in such an environment could create a fire or explosion. Such environments might include: medical use of oxygen without adequate ventilation; industrial gases (cleaning solvents; gasoline vapors; etc.); a leak of natural gas; etc.
  - Only put the handset of your telephone next to your ear when it is in normal talk mode.
  - The power adapter is intended to be correctly oriented in a vertical or floor mount position. The prongs are not designed to hold the plug in place if it is plugged into a ceiling, under-the-table or cabinet outlet.
  - For pluggable equipment, the socket-outlet shall be installed near the equipment and shall be easily accessible.
  - CAUTION:** Use only the batteries indicated in this manual. There may be a risk of explosion if a wrong type of battery is used. Use only the supplied

- rechargeable batteries or replacement batteries (BT162342/BT262342). Do not dispose of batteries in a fire. They may explode. Dispose of used battery according to the instruction. Disconnect the telephone line from the equipment before open the battery door.
- Do not use the battery in following conditions:
    - High or low extreme temperature during use, storage or transportation.
    - Replacement of a battery with an incorrect type that can defeat a safeguard.
    - Disposal of a battery into fire or a hot oven, or mechanically crushing or cutting of a battery, that can result in an explosion.
    - Leaving a battery in an extremely high temperature surrounding environment that can result in an explosion or the leakage of flammable liquid or gas.
    - A battery subjected to extremely low air pressure that can result in an explosion or the leakage of flammable liquid or gas.
- Use only the adapter included with this product. Incorrect adapter polarity or voltage can seriously damage the product.
  - The applied nameplate is located at the bottom or near of the product.
- SAVE THESE INSTRUCTIONS**
- Use only the batteries provided or equivalent. To order a replacement, visit our website at [www.vtechphones.com](http://www.vtechphones.com) or call 1 (800) 595-9511. In Canada, go to [phones.vtechcanada.com](http://phones.vtechcanada.com) or call 1 (800) 267-7377.
  - Do not dispose of the battery in a fire. Check with local waste management codes for special disposal instructions.
  - Do not open or mutilate the battery. Released electrolyte is corrosive and may cause burns or injury to the eyes or skin. The electrolyte may be toxic if swallowed.
  - Exercise care in handling batteries in order not to create a short circuit with conductive materials.
  - Charge the battery provided with this product only in accordance with the instructions and limitations specified in this manual.
- Precautions for users of implanted cardiac pacemakers**  
Cardiac pacemakers (applies only to digital cordless telephones); Wireless Technology Research, LLC (WTR), an independent research entity, led a multidisciplinary evaluation of the interference between portable wireless telephones and

- implanted cardiac pacemakers. Supported by the U.S. Food and Drug Administration, WTR recommends to physicians that:
- Pacemaker patients:**
- Should keep wireless telephones at least six inches from the pacemaker.
  - Should NOT place wireless telephones directly over the pacemaker, such as in a breast pocket, when it is turned ON.
  - Should use the wireless telephone at the ear opposite the pacemaker.
- WTR's evaluation did not identify any risk to bystanders with pacemakers from other persons using wireless telephones.
- ABOUT CORDLESS TELEPHONES**
- Privacy:** The same features that make a cordless telephone convenient create some limitations. Telephone calls are transmitted between the telephone base and the cordless handset by radio waves, so there is a possibility that the cordless telephone conversations could be intercepted by radio receiving equipment within range of the cordless handset. For this reason, you should not think of cordless telephone conversations as being as private as those on corded telephones.
  - Electrical power:** The telephone base of this cordless telephone must be connected to a working electrical outlet. The electrical outlet should not be controlled by a wall switch. Calls cannot be made from the cordless handset if the telephone base is unplugged, switched off or if the electrical power is interrupted.
  - Potential TV interference:** Some cordless telephones operate at frequencies that may cause interference to televisions and VCRs. To minimize or prevent such interference, do not place the telephone base of the cordless telephone near or on top of a TV or VCR. If interference is experienced, moving the cordless telephone farther away from the TV or VCR often reduces or eliminates the interference.
  - Rechargeable batteries:** Exercise care in handling batteries in order not to create a short circuit with conducting material such as rings, bracelets and keys. The battery or conductor may overheat and cause harm. Observe proper polarity between the battery and the battery charger.
  - Nickel-metal hydride rechargeable batteries:** Dispose of these batteries in a safe manner. Do not burn or puncture the battery. Like other batteries of this type, if burned or punctured, they could release caustic material which could cause injury.

## WHAT'S IN THE BOX

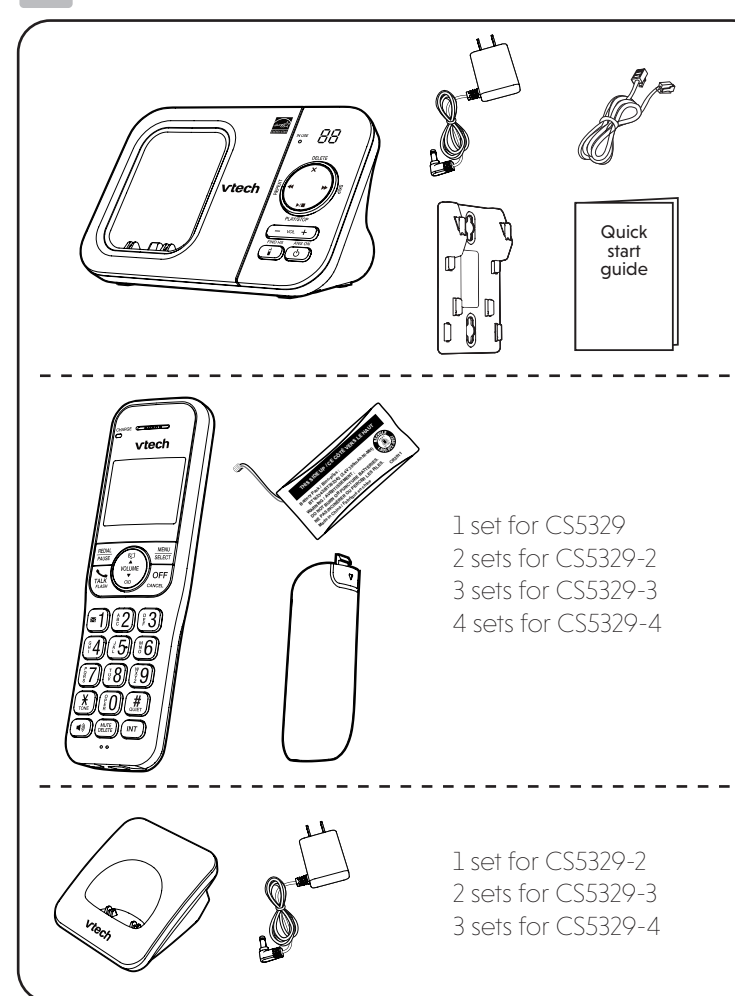

## CONNECT AND ACTIVATE

- Connect the telephone base**  
If you subscribe to digital subscriber line (DSL) high-speed Internet service through your telephone line, make sure you connect a DSL filter (not included) to the telephone wall jack.
- Install the battery**  
1 set for CS5329  
2 sets for CS5329-2  
3 sets for CS5329-3  
4 sets for CS5329-4
- Connect the charger**
- Charge the battery**  
12hrs

## SETUP

After you install your telephone or power returns following a power outage and battery depletion, the handset will prompt you to set the date and time, and to configure the answering system through voice guide.

**Date and time**  
Follow the steps below to set the date and time. For example, if the date is 25 January, 2023, and the time is 10:59 AM:

- Enter the date.
- Press SELECT.
- Enter the time.
- Press SELECT.

## BASIC OPERATION

**Make a call**

- Press **TALK FLASH** - OR -
- Enter the phone number

---

**Answer a call**

Press **TALK FLASH** - OR - - OR - Press any dialing keys to answer

---

**End a call**  
Press **OFF CANCEL**

**Speakerphone**  
Press

**Volume**  
Press

## PHONEBOOK

**Phonebook**  
The phonebook can store up to 50 entries, which are shared by all handsets. Each entry may consist of a telephone number up to 30 digits, and a name up to 15 characters.

**Add a phonebook entry**

- Enter the phone number.
- Press MENU.
- Press SELECT.
- Enter the name.
- Press SELECT.

**Review phonebook entries**

- Press
- Press to browse the entries.

**Delete a phonebook entry**

When your desired phonebook entry displays on the handset screen:

- Press DELETE.
- Press SELECT.

## CALLER ID

**Caller ID**  
If you subscribe to caller ID service, information about each caller appears after the first or second ring. The caller ID log stores up to 30 entries. Each entry has up to 24 digits for the phone number and 15 characters for the name.

**Review caller ID log entries**

- Press CID.
- Press to browse the entries.

**Save a caller ID log entry to the phonebook**

**Review the caller ID log entries and when your desired entry displays on the handset screen:**

- Press MENU.
- Press SELECT to select To phonebook.
- Edit the phone number if needed, then press SELECT.
- Edit the name if needed, then press SELECT.

**Dial a caller ID log entry**

**Review the caller ID log entries and when your desired entry displays on the handset screen:**

Press **TALK FLASH** - OR -

**Delete a caller ID log entry**

**Review the caller ID log entries and when your desired entry displays on the handset screen:**

Press **DELETE** to delete.

## Voice guide for answering system

After setting the date and time, the handset will display **Voice guide to...** and set up **Ans sys?** alternatively.

This feature assists you to do the basic setup of the answering system. You can follow the voice guide to record your own announcement, set the number of rings and the message alert tone.

**When the handset prompts you to set up the answering system via voice guide**

Press **SELECT**. Setup your answering system by inputting the designated numbers as instructed in the voice guide.

**When the handset prompts you to set the date and time**

Date: MM/DD/YY  
Date: 01/25/23

Time: 1?:MM  
Time: 10:59 AM

1 Enter the date.  
2 Press SELECT.  
3 Enter the time.  
4 Press SELECT.

## LCD LANGUAGE SETTING

If you accidentally set the LCD language to Spanish or French, press **MENU** and then enter **\*364#** to change the handset LCD language back to English while the handset is not in use.

# CALL BLOCK

## Call Block

If you subscribe to caller ID service, you can set the telephone to block unknown calls and certain undesired calls. The call block list can store up to 150 entries.

### Add a call block entry

- Press **MENU**.
- Press **▼/▲** to scroll to **Call block**, then press **SELECT**.
- Press **SELECT** to select **Block list**.
- Press **▼/▲** to scroll to **Add new entry**, then press **SELECT**.
- Enter number then press **SELECT**.
- Enter name then press **SELECT**.

### Review a call block list entry

- Press **MENU**.
- Press **▼/▲** to scroll to **Call block**, then press **SELECT**.
- Press **SELECT** to select **Block list**.
- Press **SELECT** to select **Review**.
- Press **▼/▲** to browse the entries.

### Delete a call block list entry

- Press **DELETE** to delete.

### Block unknown calls

- Press **MENU**.
- Press **▼/▲** to scroll to **Call block**, then press **SELECT**.
- Press **▼/▲** to scroll to **Call w/o num**, then press **SELECT**.
- Press **▼/▲** to scroll to **Block**, then press **SELECT**.

# ANSWERING SYSTEM

## About the built-in answering system and voicemail service

For message recording, your telephone has a built-in answering system, and it also supports voicemail service offered by your telephone service provider (subscription is required, and fee may apply).

### Built-in answering system VS Voicemail service

	BUILT-IN ANSWERING SYSTEM	VOICEMAIL SERVICE
SUPPORTED BY	Telephone system	Telephone service provider
SUBSCRIPTION	No	Yes
FEES	No	May apply
ANSWER INCOMING CALLS	<ul style="list-style-type: none"> <li>After 3 rings by default.</li> <li>It can be changed via handset menu.</li> </ul>	<ul style="list-style-type: none"> <li>Usually after 2 rings.</li> <li>It can be changed by contacting your telephone service provider.</li> </ul>
STORAGE	Telephone base	Server or System
DISPLAY NEW MESSAGES	<ul style="list-style-type: none"> <li>Handset - <b>XX new messages</b></li> <li>Telephone base - Message window</li> </ul>	<ul style="list-style-type: none"> <li>Handset - <b>V M</b> and <b>New voicemail</b></li> </ul>
RETRIEVE MESSAGES	<ul style="list-style-type: none"> <li>Press <b>▶/◀</b> on the telephone base; OR</li> <li>Press <b>MENU</b>, and then select <b>Play messages</b> on the handset; OR</li> <li>Access remotely with an access code.</li> </ul>	<ul style="list-style-type: none"> <li>Press <b>V M</b> on the dialpad, and enter an access number and/or passcode from your telephone service provider.</li> <li>Press and hold <b>V M</b> to dial if you have saved the access number.</li> </ul>

### Turn the built-in answering system on or off On the telephone base:

Press to turn on; press again to turn off.

### Set number of rings

You can set the answering system to answer an incoming call after 2, 3, 4, 5 or 6 rings; or Toll saver.

If you choose **Toll saver**, the answering system answers a call after two rings when you have new messages, or after four rings when you have no new messages. This enables you to check for new messages and avoid paying unnecessary long distance charges if you are calling from outside your local area.

- Press **MENU**.
- Press **▼/▲** to scroll to **Answering sys**, then press **SELECT**.
- Press **▼/▲** to scroll to **Ans sys setup**, then press **SELECT**.
- Press **▼/▲** to scroll to **# of rings**, then press **SELECT**.
- Press **▼/▲** to scroll to the desired number of rings, then press **SELECT**.

### Message playback

#### On the telephone base:

Press

#### - OR -

#### On a handset:

Press

#### 1 Press MENU. 2 Press SELECT to select Play messages.

### Skip a message

Press

### Repeat the playing message

Press

### Delete all old messages

Press

### Play the previous message

Press

### SET VOICE LANGUAGE (FOR CANADA VERSION ONLY)

The voice prompt language is preset to English. You can select English or French to be used for the voice prompts in your answering system.

- Press **MENU**.
- Press **▼/▲** to scroll to **Answering sys**, then press **SELECT**.
- Press **▼/▲** to scroll to **Ans sys setup**, then press **SELECT**.
- Press **▼/▲** to scroll to **Voice language**, then press **SELECT**.
- Press **▼/▲** to scroll to **English** or **Français**, then press **SELECT**.

# NEED HELP?

For operations and guides to help you using your telephone, and for latest information and supports, go and check the online help topics and online FAQs. Use your smartphone or mobile device to access our online help.

- Go to <https://help.vtechphones.com/cs5329> [in US] or <https://phones.vtechcanada.com/en/support/technical-support/product/4362> [in Canada];
- OR
- Scan the QR code on the right. Launch the camera app or QR code scanner app on your smartphone or tablet. Hold the device's camera up to the QR code and frame it. Tap the notification to trigger the redirection of the online help.
- If the QR code is not clearly displayed, adjust your camera's focus by moving your device closer or further away until it is clear.

You can also call our Customer Support at 1 (800) 595-9511 [in US] or 1 (800) 267-7377 [in Canada] for help.

# FOR C-U-L COMPLIANCE ONLY

## Mesures de sécurité importantes

- Afin de réduire les risques d'incendie, de blessures corporelles ou d'électrocution, suivez toujours ces mesures préventives de base lorsque vous utilisez votre téléphone :
- Lisez et comprenez bien toutes les instructions.
  - Observez toutes les instructions et mises en garde inscrites sur l'appareil. Débranchez ce téléphone de la prise murale avant de le nettoyer. N'utilisez pas de nettoyeurs liquides ni en aérosol. N'utilisez qu'un chiffon doux et légèrement humecté.
  - ATTENTION:** Ne pas installer le socle téléphonique à une hauteur supérieure à 2 mètres.
  - N'utilisez pas ce produit près de l'eau, tel que près d'un bain, d'un lavabo, d'un évier de cuisine, d'un bac de lavage ou d'une piscine, ou dans un sous-sol humide ou celui-ci se baigne.
  - ATTENTION:** Ne pas installer le socle téléphonique à une hauteur supérieure à 2 mètres.
  - N'utilisez pas ce produit près de l'eau, tel que près d'un bain, d'un lavabo, d'un évier de cuisine, d'un bac de lavage ou d'une piscine, ou dans un sous-sol humide ou celui-ci se baigne.
  - Ne déposez pas ce téléphone sur un chariot, support ou table chancelants. L'appareil pourrait tomber et être sérieusement endommagé.
  - Évitez d'installer le système téléphonique dans les endroits soumis à une température extrême, à la lumière directe du soleil ou à proximité immédiate d'autres appareils électriques ou électroniques. Protégez votre téléphone contre les sources d'humidité, la poussière, les vapeurs et les liquides corrosifs.
  - Le boîtier de l'appareil est doté de fentes et d'ouvertures d'aération situées à l'arrière ou en dessous. Afin d'empêcher la surchauffe, ces ouvertures ne doivent pas être obstruées en plaçant l'appareil sur un lit, divan, tapis ou autre surface similaires. Ne placez pas cet appareil à proximité d'un élément de chauffage d'une plinthe électrique. De plus, ne l'installez pas dans une unité murale ou un cabinet fermé qui ne possède pas d'aération adéquate.
  - Ne faites fonctionner cet appareil qu'avec le type d'alimentation indiqué sur les étiquettes de l'appareil. Si vous ne connaissez pas le voltage de votre maison, consultez votre marchand ou votre fournisseur d'électricité.
  - Ne déposez rien sur le cordon d'alimentation. Installez cet appareil dans un endroit

undesired operation. Privacy of communications may not be ensured when using this telephone.

To ensure safety of users, the FCC/ISED has established criteria for the amount of radio frequency energy that can be safely absorbed by a user or bystander according to the intended usage of the product. This product has been tested and found to comply with the FCC/ISED criteria. The handset may be safely held against the ear of the user. The telephone base shall be installed and used such that parts of the user's body other than the hands are maintained at a distance of approximately 20 cm (8 inches) or more.

This Class B digital apparatus complies with Canadian requirement: CAN ICES-3 (B)/NMB-3(B).

### FCC Part 68 and NCB

This equipment complies with Part 68 of the FCC rules and with technical requirements adopted by the Administrative Council for Terminal Attachments (ACTA). The label on the back or bottom of this equipment contains, among other things, a product identifier in the format USAAEE#TXXXX. This identifier must be provided to your telephone service provider upon request.

The plug and jack used to connect this equipment to premises wiring and the telephone network must comply with applicable Part 68 rules and technical requirements adopted by ACTA. A compliant telephone cord and modular plug is provided with this product. It is designed to be connected to a compatible modular jack that is also compliant. An RJ11 jack should normally be used for connecting to a single line and an RJ14 jack for two lines. See the installation instructions in the user's manual.

The Ringer Equivalence Number (REN) is used to determine how many devices you may connect to your telephone line and still have them ring when you are called. The REN for this product is encoded as the 6th and 7th characters following the US: in the product identifier (e.g., if ## is 03, the REN is 0.3). In most, but not all areas, the sum of all RENs should be five (5.0) or less. For more information, please contact your telephone service provider.

This equipment must not be used with Party Lines. If you have specially wired alarm dialing equipment connected to your telephone line, ensure the connection of this equipment does not disable your alarm equipment. If you have questions about what will disable alarm equipment, consult your telephone service provider or a qualified installer.

If this equipment is malfunctioning, it must be unplugged from the modular jack until the problem has been corrected. Repairs to this telephone equipment can only be made by the manufacturer or its authorized agents. For repair procedures, follow the instructions outlined under the **Limited warranty**.

If this equipment is causing harm to the telephone network, the telephone service provider may temporarily discontinue your telephone service. The telephone service provider is required to notify you before interrupting service. If advance notice is not practical, you will be notified as soon as possible. You will be given the opportunity to correct the problem and the telephone service provider is required to inform you of your right to file a complaint with the FCC. Your telephone service provider may make changes in its facilities, equipment, operation, or procedures that could affect the proper functioning of this product. The telephone service provider is required to notify you if such changes are planned.

If this product is equipped with a corded or cordless handset, it is hearing aid compatible.

If this product has memory dialing functions, you may choose to store emergency telephone numbers (e.g., police, fire, medical) in these locations. If you do store or test

sécurité, la où personne ne pourra trébucher sur la ligne d'alimentation ni le cordon téléphonique modulaire.

- Ne déposez rien sur le cordon d'alimentation ou court-circuiter des pièces, ce qui constituerait un risque d'incendie ou d'électrocution. N'échappez pas de liquides dans l'appareil.
- Afin de réduire les risques d'électrocution, ne démontez pas l'appareil, mais apportez-le plutôt à un centre de service qualifié s'il doit être réparé. En enlevant le couvercle, vous vous exposez à des tensions dangereuses ou autres dangers similaires. Un remontage inadéquat peut être à l'origine d'une électrocution lors d'une utilisation ultérieure de l'appareil. Débranchez l'appareil avant de procéder au nettoyage. Utilisez un chiffon humide et doux.
- Ne surchargez pas les prises de courant et les rallonges.
- Débranchez cet appareil de la prise de courant et communiquez avec le fabricant de l'appareil si le socle et/ou la clé dans les cas suivants :
  - Lorsque le cordon d'alimentation est endommagé ou écorché.
  - Si du liquide a été exposé dans l'appareil.
  - Si l'appareil a été exposé à une source d'humidité telle que la pluie ou l'eau.
  - Si le produit ne fonctionne pas normalement en respectant les instructions de fonctionnement. Réglez uniquement les commandes indiquées dans le les instructions de fonctionnement. Les réglages incorrects des autres commandes pourraient provoquer un dommage qui pourrait exiger un travail exhaustif de la part d'un technicien autorisé afin de rétablir le fonctionnement normal de l'appareil.
  - Inclus si le produit a été échappé et que le socle et/ou le combiné a été endommagé.
  - Si le produit affiche une nette diminution de sa performance.
- Évitez d'utiliser un téléphone (autre qu'un sans fil) pendant un orage. Les éclairs peuvent être à l'origine d'une électrocution.
- N'utilisez pas le téléphone pour rapporter une fuite de gaz à proximité de la fuite. En certaines circonstances, une flamme peut être provoquée lorsque l'adaptateur est branché à une prise de courant, ou lorsque le combiné est déposé sur le socle. Ceci est un événement commun associé à la fermeture d'un circuit électrique. L'utilisateur ne devrait pas brancher le téléphone à une prise de courant, et ne devrait pas déposer le combiné chargé sur le socle, si le téléphone se trouve à proximité d'un endroit comportant des concentrations de gaz inflammables, à moins que la ventilation soit adéquate. Une flamme peut dans un tel endroit pourrait provoquer un incendie ou une explosion. De tels environnements peuvent comprendre: des endroits où l'on utilise de l'oxygène médical sans ventilation adéquate; des gaz industriels (dissolvants de nettoyage, des vapeurs d'essence, etc.); une fuite de gaz naturel, etc.
- Ne placez pas ce produit sur un support ou table chancelants. L'appareil pourrait tomber et être sérieusement endommagé.
- Ces adaptateurs ont été conçus pour être orientés en position verticale ou montés au sol. Les broches ne sont pas conçues pour maintenir l'adaptateur en place si celui-ci est bariqué dans une prise au plafond ou sous une table/ armoire.
- Pour le MATÉRIEL RACCORDE PAR PRISE DE COURANT, le socle de prise de courant doit être installé à proximité du matériel et doit être aisément accessible.
- MISE EN GARDE:** Il peut y avoir un risque d'explosion si vous utilisez le mauvais type de pile pour le téléphone. N'utilisez que les piles rechargeables incluses ou les piles de recharge (BT162342/BT2642). N'incinerez pas les piles. Elles-ci risqueraient d'exploser. Mettre au rebut les batteries usagées conformément aux instructions du fabricant. Débrancher les lignes téléphoniques avant le remplacement des piles.
  - Évitez d'utiliser la batterie dans les conditions suivantes:
    - des températures extrêmes faibles ou élevées auxquelles une batterie peut être soumise pendant l'utilisation, le stockage ou le transport;
    - Remplacement d'une batterie par un type incorrect pouvant supprimer une protection;

emergency numbers, please: Remain on the line and briefly explain the reason for the call before hanging up. Perform such activities in off-peak hours, such as early morning or late eveninging.

### Industry Canada

This device contains licence-exempt transmitter(s)/receiver(s) that comply with Innovation, Science and Economic Development Canada's licence-exempt RSS(s). Operation is subject to the following two conditions:

- This device may not cause interference.
- This device must accept any interference, including interference that may cause undesired operation of the device.

Privacy of communications may not be ensured when using this telephone.

The Ringer Equivalence Number (REN) for this terminal equipment is 0.1. The REN indicates the maximum number of devices allowed to be connected to a telephone interface. The termination of an interface may consist of any combination of devices subject only to the requirement that the sum of the RENs of all the devices not exceed five.

This product meets the applicable Innovation, Science and Economic Development Canada technical specifications.

### CALIFORNIA ENERGY COMMISSION BATTERY CHARGING TESTING INSTRUCTIONS

This telephone is set up to comply with the energy-conserving standards right out of the box. These instructions are intended for California Energy Commission (CEC) compliance testing only. When the CEC battery charging testing mode is activated, all telephone functions, except battery charging, will be disabled.

#### To activate the CEC battery charging testing mode:

- Unplug the telephone base power adapter from the power outlet. Make sure all handsets are plugged with charged batteries before proceeding.
- While you **press and hold** **▶/◀**/**FIND HS**, plug the telephone base power adapter back to the power outlet.
- After about 20 seconds, when the **IN USE** light starts flashing, release **▶/◀**/**FIND HS** and immediately press it again within two seconds.

When the phone successfully enters the CEC battery charging testing mode, all handsets display **To Register HS...** and **...see manual** alternately.

When the phone fails to enter this mode, repeat steps 1 to 3 above.

#### To deactivate the CEC battery charging testing mode:

- Unplug the telephone base power adapter from the power outlet, and then plug it back. Then the telephone base is powered up as normal.
- Press and hold** **▶/◀**/**FIND HS** on the telephone base for about four seconds until the **IN USE** light turns on.
- Press #0** on the handset and it shows **Registering....** The handset shows **Registered** and you hear a beep when the registration process completes. This process takes about 60 seconds.

» mise au rebut d'une batterie dans un feu ou dans un feu chaud, ou écrasement mécanique ou coupure d'une batterie, susceptible de provoquer une explosion;

- maintien d'une batterie dans un environnement à très haute température pouvant provoquer une explosion ou la fuite de liquide ou de gaz inflammables;
- batterie soumise à une pression de l'air extrêmement faible pouvant provoquer une explosion ou la fuite de liquide ou de gaz inflammables.
- N'utilisez que les adaptateurs inclus avec ce produit. L'utilisation d'un adaptateur dont la polarité ou la tension serait inadéquate risque d'endommager sérieusement le produit et mettre en danger votre sécurité en péri.
- La plaque signalétique appliquée est située au bas ou à proximité du produit. **CONSERVEZ CES INSTRUCTIONS**

### Stimulateurs cardiaques implantés dans l'organisme

Les stimulateurs cardiaques (s'applique uniquement aux téléphones numériques sans fil) : L'organisme "Wireless Technology Research, LLC (WTR)", une firme de recherche indépendante, a mené une évaluation pluridisciplinaire des interférences entre les téléphones sans fil portatifs et les stimulateurs cardiaques implantés dans l'organisme. Appuyée par l'Administration des aliments et drogues (FDA) des États-Unis, la firme WTR recommande aux médecins :

- Il s doivent tenir le téléphone sans fil à une distance d'au moins six pouces du stimulateur cardiaque.
- Il s ne doivent PAS placer le téléphone sans fil directement sur le stimulateur cardiaque, tel que dans une poche de chemise, lorsque celui-ci est en marche.
- Il s doivent utiliser le téléphone sans fil en l'appuyant sur l'oreille qui se trouve dans la direction opposée au stimulateur cardiaque.

L'étude effectuée par l'organisme WRS n'a pas identifié de risque pour les détenteurs de stimulateurs cardiaques causés par les gens qui utilisent un téléphone sans fil à proximité de ceux-ci.

### Confidentialité

Les mêmes caractéristiques qui constituent des avantages pour les téléphones sans fil réduisent également des restrictions. Les appels téléphoniques sont transmis entre le combiné sans fil et le socle par le biais d'ondes radio; il y a donc la possibilité que vos conversations téléphoniques sans fil soient interceptées par des équipements de réception radio se trouvant dans la portée du combiné sans fil. Pour cette raison, vous ne devez pas divulguer des communications téléphoniques sans fil comme étant aussi confidentielles que celles des téléphones à cordons.

### Alimentation électrique

Le socle de ce téléphone sans fil doit être branché à une prise électrique fonctionnelle. La prise électrique ne doit pas être contrôlée par un interrupteur à distance. Les appels ne pourront pas être effectués du combiné sans fil si le socle est débranché ou mis hors tension ou si le courant est coupé.

### Possibilité d'interférences aux téléviseurs

Certains téléphones sans fil fonctionnent sur des fréquences pouvant causer des interférences aux téléviseurs et aux magnétoscopes. Pour réduire ou prévenir de telles interférences, ne placez pas le socle

de téléphone sans fil près ou sur un téléviseur ou magnétoscope. S'il y a présence de parasites, il est conseillé d'éloigner le téléphone sans fil du téléviseur ou du magnétoscope afin de réduire possiblement les interférences.

### Piles rechargeables

Manipulez les piles avec soin afin de ne pas les court-circuiter avec des bagues, bracelets ou clés. Les piles ou le conducteur peut surchauffer et causer des blessures. Respectez la polarité adéquate entre la pile et le chargeur.

### Les bloc-piles rechargeables à Hydrure métallique de nickel

Placez ces blocs-piles de manière écologique et sécuritaire. Ne les incinerez pas et ne les percez pas. Tel que les autres piles de ce type, elles pourraient dégager une matière toxique qui peut causer des blessures corporelles si elles sont brûlées ou percées.

# THE RBRC SEAL

The RBRC seal on the nickel-metal hydride battery indicates that VTech Communications, Inc. is voluntarily participating in an industry program to collect and recycle these batteries at the end of their useful lives, when taken out of service within the United States and Canada.

The program provides a convenient alternative to placing used nickel-metal hydride batteries into the trash or municipal waste, which may be illegal in your area.

VTech's participation makes it easy for you to drop off the spent battery at local retailers participating in the program or at authorized VTech product service centers. Please call **1 (800) 8 BATTERY®** for information on Ni-MH battery recycling and disposal bans, restrictions in this program is part of its commitment to protecting our environment and conserving natural resources.

The RBRC seal and 1 (800) 8 BATTERY® are registered trademarks of Call2recycle, Inc.

# FCC, ACTA AND IC REGULATIONS

## NOTE:

This equipment has been tested and found to comply with the requirements for a Class B digital device under Part 15 of the Federal Communications Commission (FCC) rules. These requirements are intended to provide reasonable protection against harmful interference in a residential installation. This equipment generates, uses and can radiate radio frequency energy and, if not installed and used in accordance with the instructions, may cause harmful interference to radio communications. However, there is no guarantee that interference will not occur in a particular installation. If this equipment does cause harmful interference to radio or television reception, which can be determined by turning the equipment off and on, the user is encouraged to try to correct the interference by one or more of the following measures:

- Reorient or relocate the receiving antenna.
- Increase the separation between the equipment and receiver.
- Connect the equipment into an outlet on a circuit different from that to which the receiver is connected.
- Consult the dealer or an experienced radio/TV technician for help.

**WARNING:** Changes or modifications to this equipment not expressly approved by the party responsible for compliance could void the user's authority to operate the equipment.

This device complies with Part 15 of the FCC rules. Operation is subject to the following two conditions: (1) this device may not cause harmful interference, and (2) this device must accept any interference received, including interference that may cause

- Charges for installation or set up, adjustment of customer controls, and installation or repair of systems outside the unit.

### How do you get warranty service?

To obtain warranty service in the United States of America, please visit our website at [www.vtechphones.com](http://www.vtechphones.com) or call 1 (800) 595-9511. In Canada, go to [phones.vtechcanada.com](http://phones.vtechcanada.com) or dial 1 (800) 267-7377.

**NOTE:** Before calling for service, please review the user's manual - a check of the Product's controls and features may save you a service call.

Except as provided by applicable law, you assume the risk of loss or damage during transit and transportation and are responsible for delivery or handling charges incurred in the transport of the Product(s) to the service location. VTech will return replaced Product under this limited warranty. Transportation, delivery or handling charges are prepaid.

VTech assumes no risk for damage or loss of the Product in transit. If the Product failure is not covered by this limited warranty, or proof of purchase does not meet the terms of this limited warranty, VTech will notify you and will request that you authorize the cost of replacement prior to any further replacement activity. You must pay for the cost of replacement and return shipping costs for the replacement of Products that are not covered by this limited warranty.

### What must you return with the Product to get warranty service?

- Return the entire original package and contents including the Product to the VTech service location along with a description of the malfunction or difficulty; and
- Include a "valid proof of purchase" (sales receipt) identifying the Product purchased (Product model) and the date of purchase or receipt; and
- Provide your name, complete and correct mailing address, and telephone number.

### Other limitations

This warranty is the complete and exclusive agreement between you and VTech. It supersedes all other written or oral communications related to this Product. VTech provides no other warranties for this Product. The warranty exclusively describes all of VTech's responsibilities regarding the Product. There are no other express warranties. No one is authorized to make modifications to this limited warranty and you should not rely on any such modification.

State/Provincial Law Rights: This warranty gives you specific legal rights, and you may also have other rights, which vary from state to state or province to province.

Limitations: Implied warranties, including those of fitness for a particular purpose and merchantability (an unwritten warranty that the Product is fit for ordinary use) are limited to one year from the date of purchase. Some states/provinces do not allow limitations on how long an implied warranty lasts, so the above limitation may not apply to you.

In no event shall VTech be liable for any indirect, special, incidental, consequential, or similar damages (including, but not limited to, lost profits or revenue, inability to use the Product or other associated equipment, the cost of substitute equipment, or claims by third parties) resulting from the use of this Product. Some states/provinces do not allow the exclusion or limitation of incidental or consequential damages, so the above limitation or exclusion may not apply to you.

### Please retain your original sales receipt as proof of purchase