



Quick start guide (Canada version) DS6673-2/DS6673-3/DS6673-6/ DS6673-6C

Introduction

This quick start guide provides you with basic installation and setup instructions.

You may refer to the **Abridged user's manual** provided in the product package for installation and operation instructions, or see the online **Complete user's manual** at www.vtechcanada.com for complete installation and operation instructions.

Telephone base and charger installation

Install the telephone base and charger as shown below.

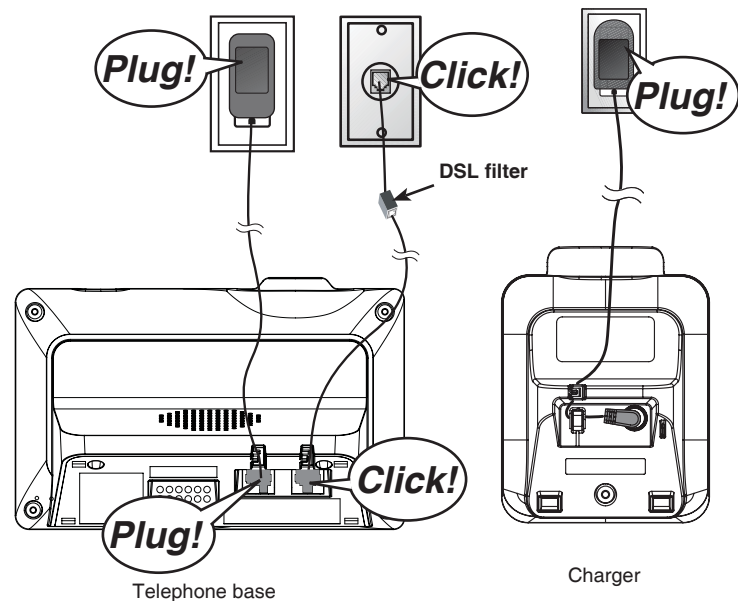

! If you subscribe to telephone service from a cable company or a VoIP service provider, contact your cable/VoIP service provider for more information.

Battery installation and charging

Install the battery as shown below.

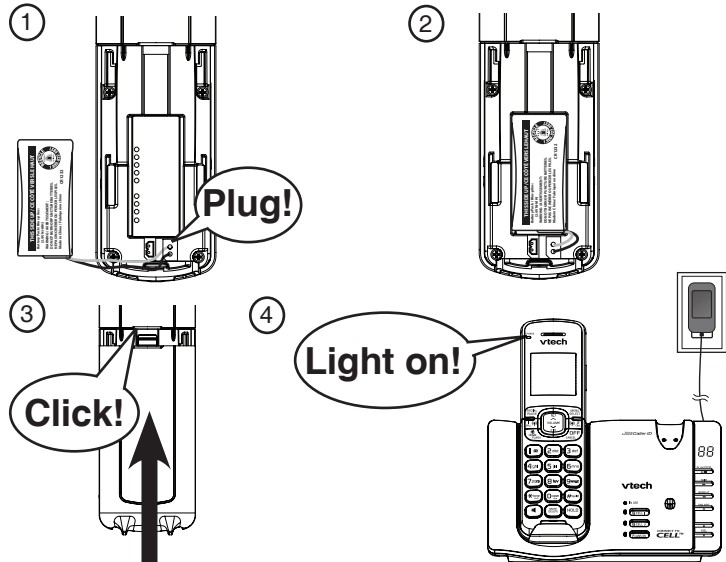

! Charge for at least 30 minutes before initial settings.
Charge for 12 hours before initial use.

IMPORTANT:

Check for a dial tone by pressing **HOME**, **CELL 1** or **CELL 2**. If you hear a dial tone, the installation is successful.

If you do not hear a dial tone:

- Make sure the installation procedures described above are properly done.
- It may be a wiring problem. If you have changed your telephone service to digital service from a cable company or a VoIP service provider, the telephone line may need to be rewired to allow all existing telephone jacks to work. Contact your cable/VoIP service provider for more information.

Headset charging

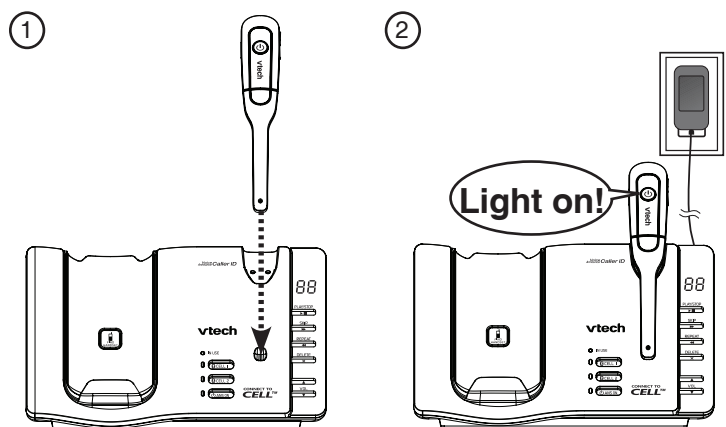

! Charge for 3 hours before initial use.

Using the handset menu

1. Press **MENU**.
 2. Press **↓** or **↑** until the screen displays the desired feature menu.
 3. Press **SELECT** to enter that menu.
- To return to the previous menu, press **CANCEL**.
 - To return to idle mode, press and hold **CANCEL**.

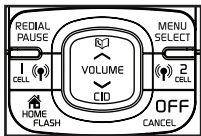

Set date and time

If you subscribe to caller ID service, the date and time are set automatically with each incoming call. You can also set the date and time manually.

1. Press **MENU** >> Scroll to **Set date/time** >> Press **SELECT**.
2. Enter month (**MM**), date (**DD**) and year (**YY**) >> Press **SELECT**.
3. Enter hour (**HH**) and minute (**MM**) >> Press **↓/↑** for **AM/PM** >> Press **SELECT**.

Set number of rings

You can set the answering system to answer an incoming call after 2, 3, 4, 5 or 6 rings; or toll saver.

1. Press **MENU** >> Scroll to **Answering sys** >> Press **SELECT**.
2. Scroll to **Ans sys setup** >> Press **SELECT**.
3. Scroll to **# of rings** >> Press **SELECT**.
4. Scroll to choose **6, 5, 4, 3, 2** or **Toll saver** >> Press **SELECT**.

Record your own announcement

You can use the preset announcement to answer calls, or replace it with your own recorded announcement.

1. Press **MENU** >> Scroll to **Answering Sys** >> Press **SELECT** twice.
2. Press **7** to start recording.
3. After the tone, speak towards the handset microphone.
4. Press **5** when done.

Bluetooth setup

To use a Bluetooth enabled cell phone with your **DS6673**, you must first pair and connect your Bluetooth cell phone(s) with the telephone base. All **DS6673** handsets can be used to make or answer calls on the cell lines.

Bluetooth wireless technology operates within a short range (a maximum of approximately 30 feet). When you pair a Bluetooth cell phone to the telephone base, place your Bluetooth cell phone closer to the telephone base to maintain sufficient signal strength. For optimal performance, keep your cell phone within 15 feet of the telephone base while using the cell line.

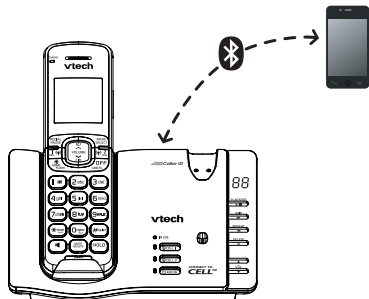

Pair and connect your first Bluetooth cell phone

i Before you begin, make sure you have cellular coverage and your Bluetooth enabled cell phone is not connected to any other Bluetooth device.

1. Press and hold **CELL 1** or **CELL 2** on the telephone base for about four seconds. You hear two beeps and the **CELL 1** or **CELL 2** light blinks.
2. Turn on the Bluetooth feature of your cell phone. Once your cell phone finds your VTech phone (**VTech DS6673**), press the appropriate key on your cell phone to continue the pairing process.
 - Your cell phone may prompt you to enter the PIN of the telephone base. The default PIN of the telephone base is **0000**.
3. When the cell phone is connected to the telephone base, you hear two beeps. The corresponding status icon (**CELL 1** or **CELL 2**) displays. The corresponding device light (**CELL 1** or **CELL 2**) turns on.

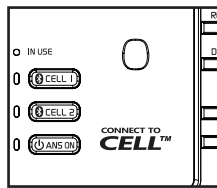

If you have trouble pairing your cell phone, it may not be compatible with your **DS6673**. Check the **Bluetooth compatibility list** at www.vtechcanada.com.

- note**
- The pairing process may take up to one minute. If the pairing process fails, try again.
 - The steps for the pairing process may vary for different cell phones. If this happens, follow the prompts on your cell phone and your **DS6673** to complete the pairing process.

Download phonebook

You can download two cell phonebooks to your **DS6673** via Bluetooth wireless technology. Each cell phonebook stores up to 1000 entries.

- note**
- Place your cell phone next to the telephone base when you download a cell phonebook to your **DS6673**.
 - Make sure the cell phone is paired to your **DS6673**, on the device list and connected to the base before you download a cell phonebook.
 - For certain cell phones, you may need to press a key on your cell phone to confirm the phonebook download.
 - For Android cell phones, you may also download your cell phone directory to your **DS6673** via the VTech Contact Share application. Go to <http://play.google.com/store/apps/details?id=com.innopage.MMI> for application download.
 - Certain cell phones do not support SIM card download. If this is the case, transfer the contacts from your SIM card to your cell phone memory first. Then, download from your cell phone memory. For more information on how to transfer contacts from your SIM card to your cell phone memory, see the user's manual of your cell phone.



1. Press **MENU** >> Scroll to **Bluetooth** >> Press **SELECT**.

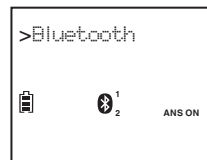

2. Scroll to **Download PB** >> Press **SELECT**.



3. The handset displays **CHOOSE DEVICE** briefly >> Scroll to the desired device >> Press **SELECT**.

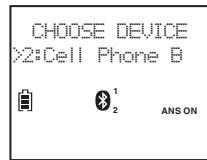
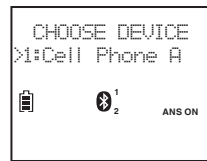

4. The handset flashes **Downloading...** During the download process, the handset displays the progress. All other idle system handsets display **Downloading...**

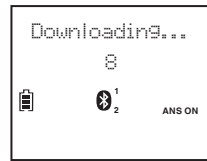

When the downloading process completes, the handset displays **Entries added: XXX** for a few seconds and then returns to the Bluetooth menu.



IMPORTANT!

Refer to the online **Complete user's manual** for a full set of installation and operation instructions. For manual download or customer service, visit our website at www.vtechcanada.com or call **1 (800) 267-7377**.

The **Bluetooth**® word mark and logos are owned by Bluetooth SIG, Inc. and any use of such marks by VTech Holdings Limited is under license. VTech Holdings Limited is a member of Bluetooth SIG, Inc. Other trademarks and trade names are those of their respective owners.