



VTech Wi-Fi HD Video Monitor allows you to stay close to your baby when you are on the move or away. This monitor is Wi-Fi enabled, which uses your home wireless network to stream live video and audio through the HD camera unit and 5-inch color screen parent unit. It allows you to maintain a constant connection to your baby.

You can also monitor from your smartphone and mobile tablet. VTech Wi-Fi HD Video Monitor uses MyVTech Baby 1080p app to let you instantly see and hear what's happening with your baby from anywhere in the world. The app can be downloaded from the App Store or the Google Play™ Store, directly from your smartphone or mobile tablet.



Quick start guide
(Canada version)

1 Set up Wi-Fi connection

1 After the parent unit is fully charged, press and hold **POWER** until the VTech logo appears on screen to power on.

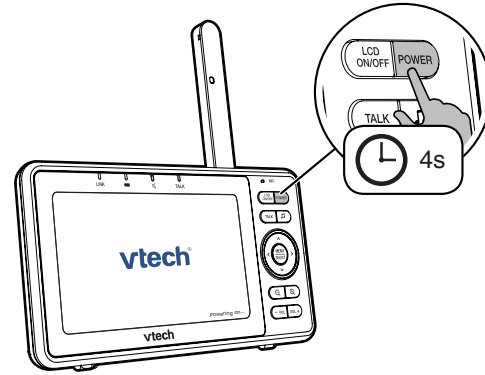

2 Press **▼** or **▲** to highlight your preferred and secured 2.4GHz Wi-Fi network with good signal strength, then press **SELECT**.
- You must select a password-protected network.

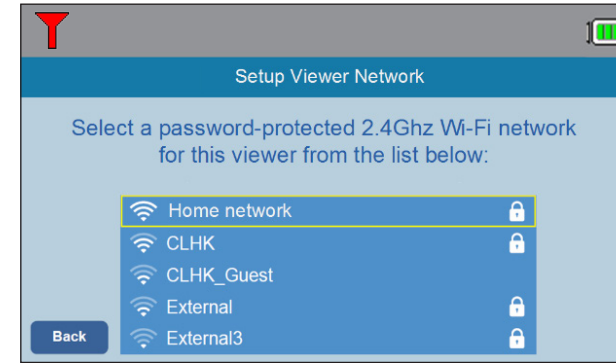

3 Enter the password of the Wi-Fi network. Press **▲**, **▼**, **◀** or **▶** to highlight the character, then press **SELECT**. When done, press **▲**, **▼**, **◀** or **▶** to highlight **Next**, then press **SELECT**.

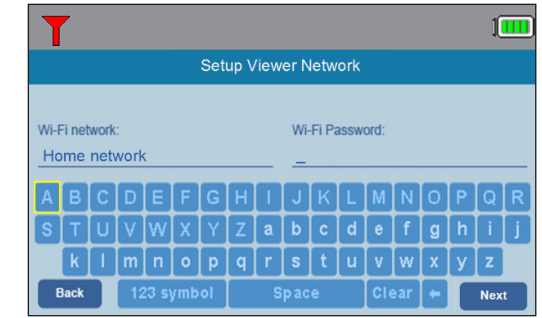

NOTE

- After you have set up the Wi-Fi connection, the parent unit may auto-prompt you for update. For details, please see **Auto-prompt for software and firmware updates** on the back.

2 Add camera

1 After connecting the parent unit to your Wi-Fi network, the system will help you add your camera. Follow the instructions shown on screen, then press **◀** or **▶** to highlight **Next**, then press **SELECT**.

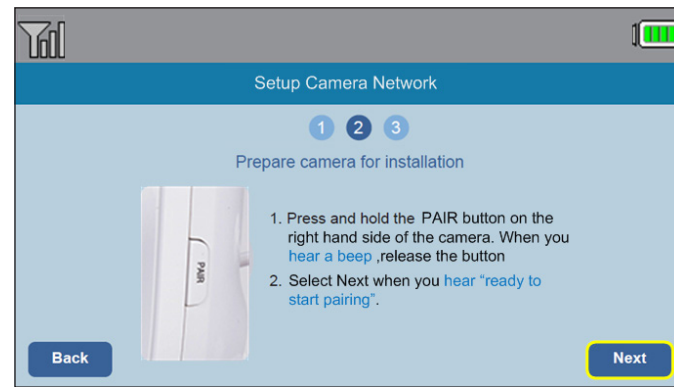
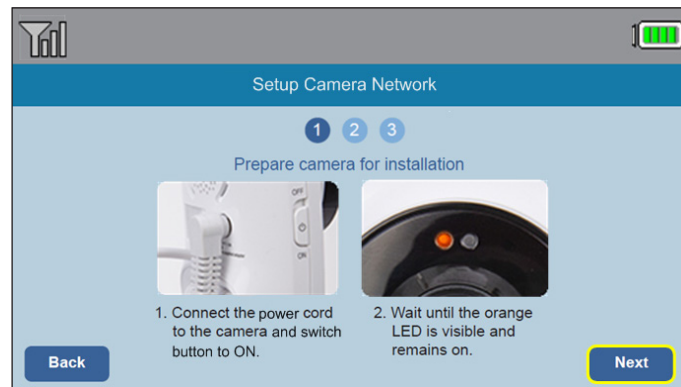

2 Once your camera is located, the system will connect the camera via the same Wi-Fi network that your parent unit has connected to. When the camera is successfully added to your parent unit, the parent unit displays the camera image.

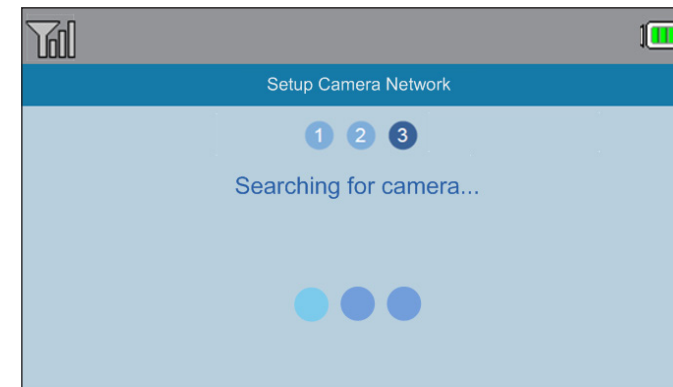

Basic operation

Use the menu

Press **MENU/SELECT** to enter the menu, choose a menu item, or save a setting. You can use the parent unit menu for advanced setting or operations, such as to play or stop the camera unit lullaby, or adjust the sound detection setting.

While in the menu:

- Press **▲**, **▼**, **◀** or **▶** to scroll among the menu options.
- Press **MENU/SELECT** to select an item.
- Press **-VOL** to return to the idle screen.

While in the submenu, press **◀** to return to the previous menu.

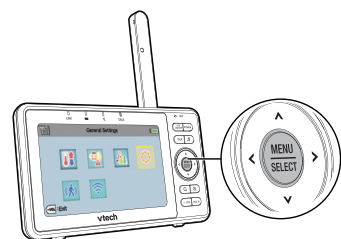

Main menu:

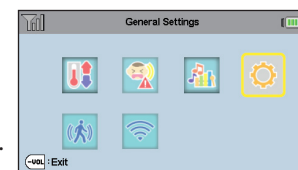

Submenu:

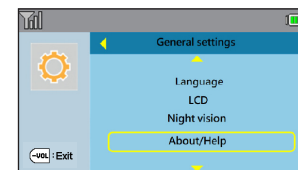

Adjust speaker volume

Press **-VOL / VOL+** to adjust your parent unit speaker volume. It determines the volume of sound transmitted from your camera unit.

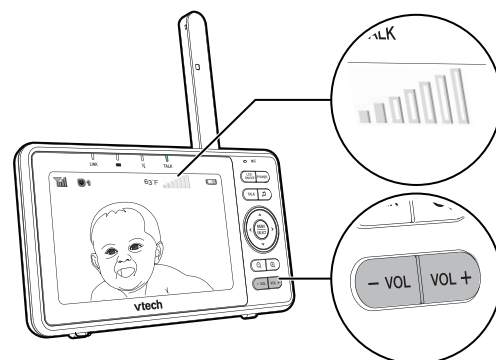

Zoom

Press **Q** or **Q** to zoom in or out.

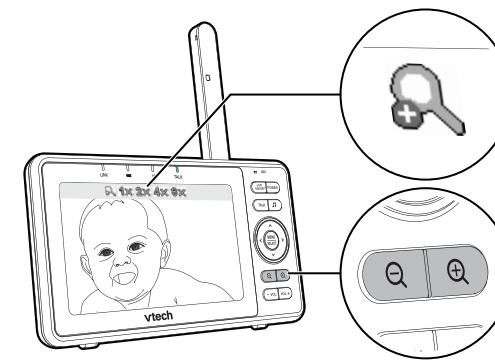

Talk to your baby unit

Press and hold **TALK** to speak to your parent unit. Your voice is transmitted to the baby unit.

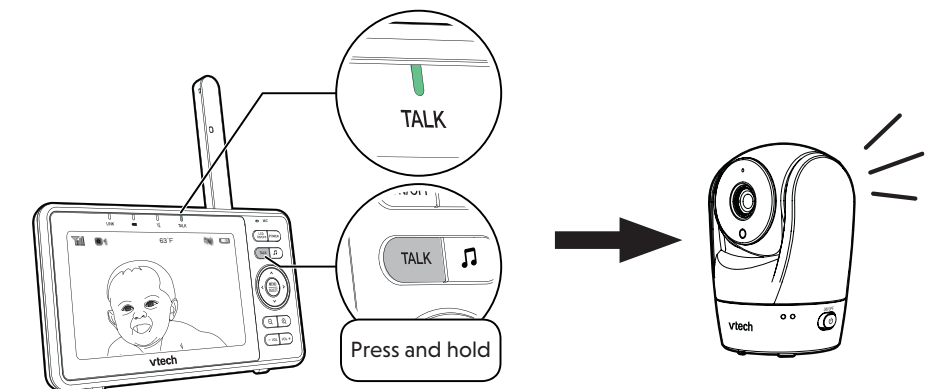

Basic operation

Turn off the screen

Press **LCD ON/OFF** to switch off the screen. You can still hear sound from the camera unit.

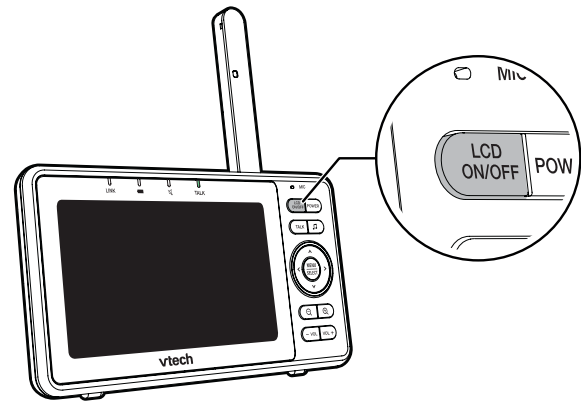

Parent unit settings

1. Press **MENU** when the parent unit is idle.
2. Press **▲**, **▼**, **◀** or **▶** to choose **General Settings**, then press **SELECT**.

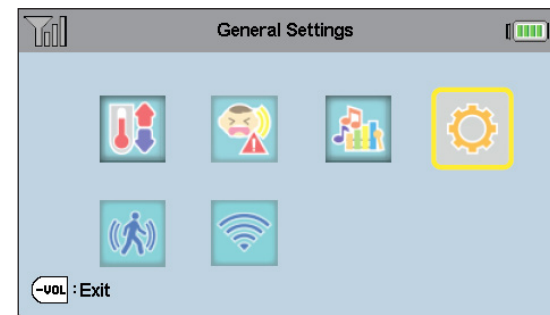

Auto-prompt for software and firmware updates

To ensure that your HD video monitor is always at its best performance, the parent unit will prompt you to update its software and the camera unit's firmware when there are new versions available.

- Press **MENU**. The new software will then be installed automatically. When the software update is complete, the parent unit will restart.

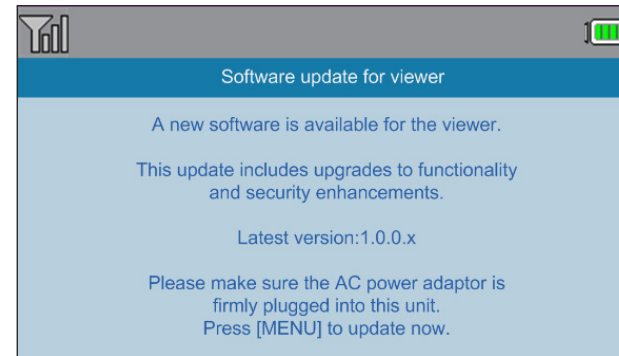

NOTE

- Updates are available only when the parent unit is connected to AC power.

Read the online manual for complete operation instructions

- 1 Driven by system updates, the software, online manual, and online FAQs will be updated periodically.
- 2 Press **▼** or **▲** to choose **About/Help**, then press **SELECT**.
- 3 Press **▼** or **▲** to choose **Help**, then press **SELECT**.
- 4 Press **▼** or **▲** to choose **User manual**, then press **SELECT**.
- 5 Press **▼** or **▲** to choose **RM5762**, then press **SELECT**. Use your smartphone or mobile device to read the online parent unit manual on our product support web page.

For latest information and supports, go and check the online manual and online FAQs.

1. Press **MENU** when the parent unit is idle.
2. Press **▼** or **▲** to choose **General Settings**, then press **SELECT**.

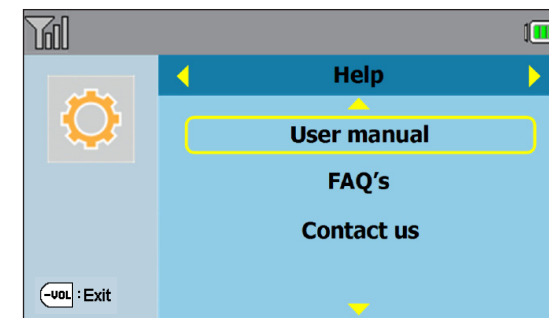
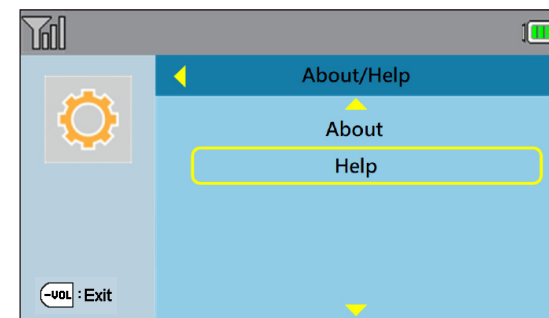
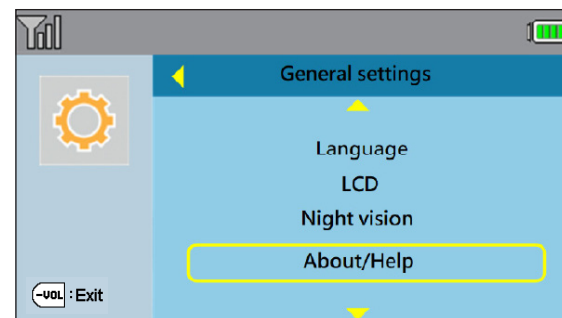
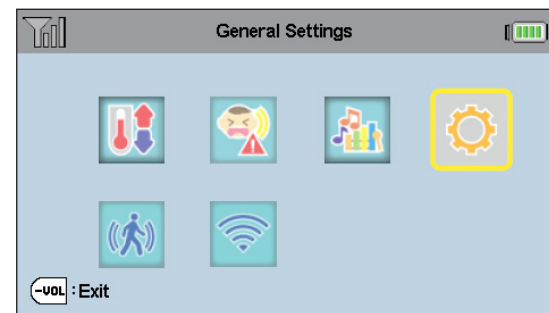

- To read the online manuals, go to help.vtechphones.com/RM5762 or scan the QR code.

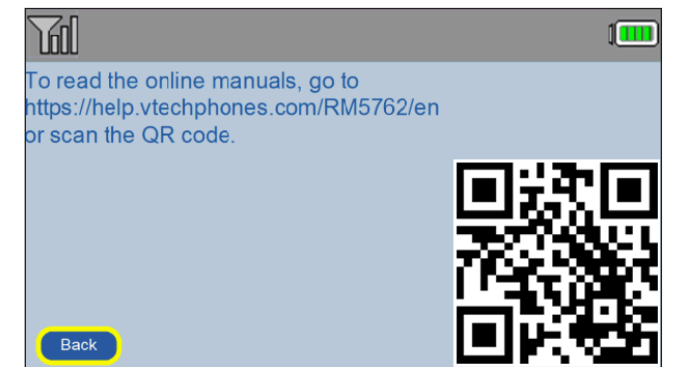

Remote monitoring

- 1 Download the free **MyVTech Baby 1080p** mobile app from the App Store or Google Play store and install it to a mobile device, then you can use your mobile device and the mobile app to monitor your areas remotely.
- 2 Tap to run the mobile app on your mobile device, and then create a camera account.
 - We recommend that you use common webmail services, such as Google Gmail for registration of your camera account.
- 3 Check your email (and Spam folder), and activate your new camera account via the email link, then sign in to your account.
- 4 Follow the instructions on the screen to add the camera to your camera account.
 - Make sure your mobile device is connected to the 2.4GHz Wi-Fi network that your parent unit has connected to when adding the camera.
- 5 Type in the security key you have set for the camera with your parent unit. See Step 3 in **2 Add camera** section.
- 6 Start using your monitoring system remotely.

NOTE

- Make sure your mobile device meets the minimum requirement for the mobile app.

Minimum requirement

- The mobile app is compatible with:
 - Android™ 4.4 or later; and
 - iOS 8.0 or later.

Install MyVTech Baby 1080p mobile app

1. Browse the App Store or the Google Play store .
2. Search for the mobile app with the keyword "myvtech baby 1080p".
3. Download and install the **MyVTech Baby 1080p** mobile app to your mobile device.

Driven by Android and iOS updates, **MyVTech Baby 1080p** mobile app, app manual, and online FAQs will be updated periodically.

Download and install the latest mobile app. For latest information and supports, go and check the app manual and online FAQs.

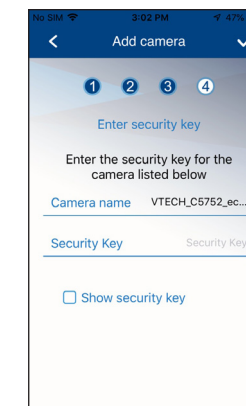
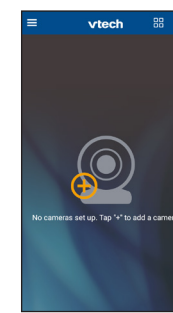
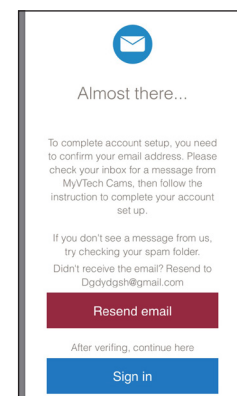
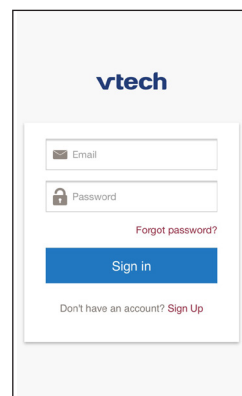

NOTES

- You must complete the camera setup in the above **1 Set up Wi-Fi connection** and **2 Add camera** sections before you can access your camera remotely.
- You can add more camera units to your HD video monitor system using the **MyVTech Baby 1080p** mobile app. Download the mobile app and create a camera account. Then, you can use the mobile app to pair your existing camera units in your parent unit to your camera account, and also pair additional camera units to your account. The mobile app can pair and access up to 10 camera units. The additional camera units can only be paired and accessed via the mobile app.
- The **MyVTech Baby 1080p** mobile app allows you to view the camera in 1080p full HD. While concurrent viewing with the parent unit, the maximum video resolution becomes 720p.
- Tap on the camera list to display the side menu, and then tap **Help** to refer to the online mobile app manual for the complete operation instructions. You can also scan the QR code on the right, or go to www.vtechphones.com/manual/RM5762/mobile, to open the manual in a web browser.

